

Unternehmen

BODENPLATTE

Fw 190D-9 & Bf 109G-14, G-14/AS
1/48 SCALE DUAL COMBO

eduard



LIMITED EDITION

11125 - NAV1

ATTENTION



UPOZORNĚNÍ



ACHTUNG



ATTENTION



注意



Carefully read instruction sheet before assembling. When you use glue or paint, do not use near open flame and use in well ventilated room. Keep out of reach of small children. Children must not be allowed to suck any part, or pull vinyl bag over the head.



Před započatím stavby si pečlivě prostudujte stavební návod. Při používání barev a lepidel pracujte v dobře větrané místnosti. Lepidla ani barvy nepoužívejte v blízkosti otevřeného ohně. Model není určen malým dětem, mohlo by dojít k požití drobných dílů.

INSTRUCTION SIGNS * INSTR. SYMBOL * INSTRUKTION SINNBILDEN * SYMBOLES * 記号の説明

OPTIONAL
VOLBA

BEND
OHNOUT

OPEN HOLE
VYVRTAT OTVOR

SYMETRICAL ASSEMBLY
SYMETRICKÁ MONTÁŽ

REMOVE
ODŘÍZNOUT

REVERSE SIDE
OTOČIT

APPLY EDUARD MASK
AND PAINT
POUŽIT EDUARD MASK
NABARVIT

PARTS



DÍLY



TEILE



PIÈCES



部品

PLASTIC PARTS

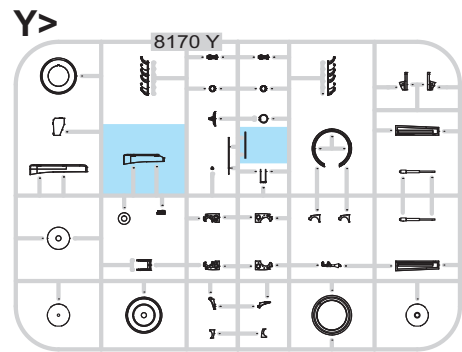
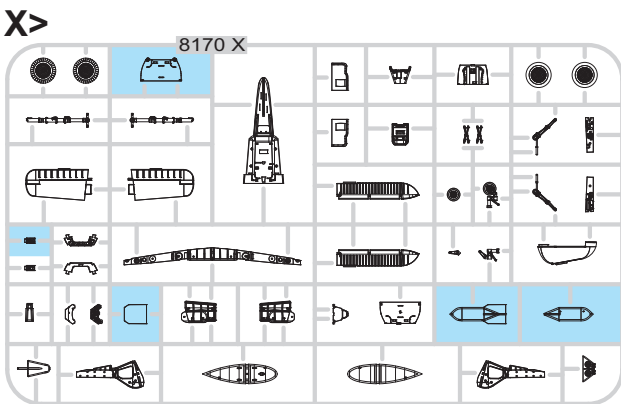
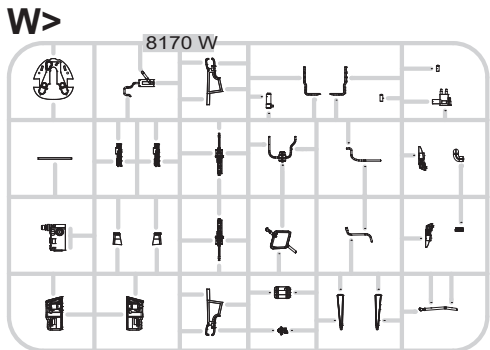
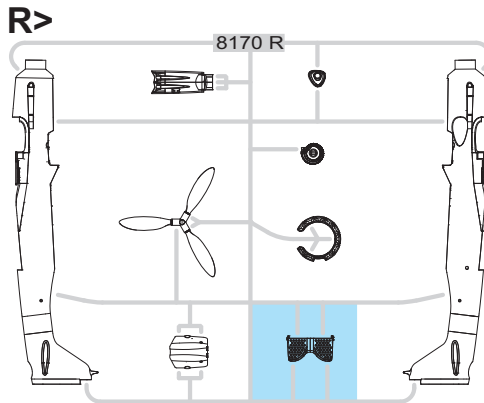
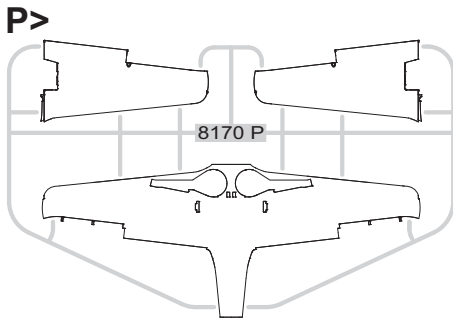
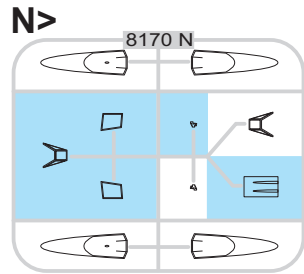

PE - PHOTO ETCHED
DETAIL PARTS

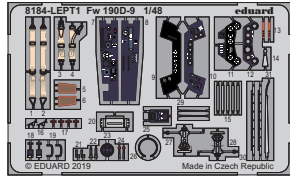

-Parts not for use. -Teile werden nicht verwendet. -Pièces à ne pas utiliser. -Tyto díly nepoužívejte při stavbě. - 使用しない部品

COLOURS



BARVY



FARBEN



PEINTURE



色

GSI Creos (GUNZE)		MISSION MODELS	
AQUEOUS	Mr.COLOR	PAINTS	
H2	C2	MMP-077	BLACK
H11	C62	MMP-001	FLAT WHITE
H12	C33	MMP-047	FLAT BLACK
H47	C41	MMP-012	RED BROWN
H65	C18	MMP-088	RLM70 BLACK GREEN
H69	C37	MMP-050	RLM75 GRAY
H70	C60	MMP-056	RLM02 GRAY
H77	C137	MMP-040	TIRE BLACK
H90	C47		CLEAR RED
H94	C138		CLEAR GREEN
H319	C319		LIGHT GREEN
H413	C113	MMP-090	RLM04 YELLOW

GSI Creos (GUNZE)		MISSION MODELS	
AQUEOUS	Mr.COLOR	PAINTS	
H414	C114		RLM23 RED
H416	C116	MMP-089	RLM66 BLACK GRAY
H417	C117	MMP-051	RLM76 LIGHT BLUE
H421	C121		RLM81 BROWN VIOLET
H422	C122	MMP-053	RLM82 LIGHT GREEN
H423	C123		RLM83 DARK GREEN
	C26		GREEN BLUE
Mr.METAL COLOR		METALLICS	
MC214		MMM-001	DARK IRON
MC218		MMM-003	ALUMINIUM
Mr.COLOR SUPER METALLIC		METALLICS	
SM01		MMC-001	SUPER CHROME

Fw 190D-9

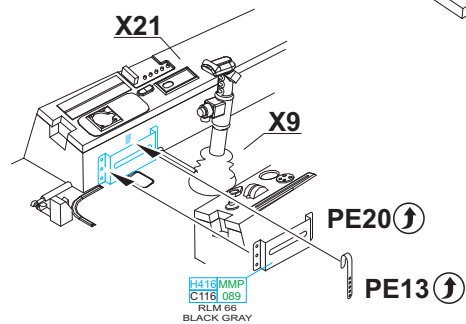
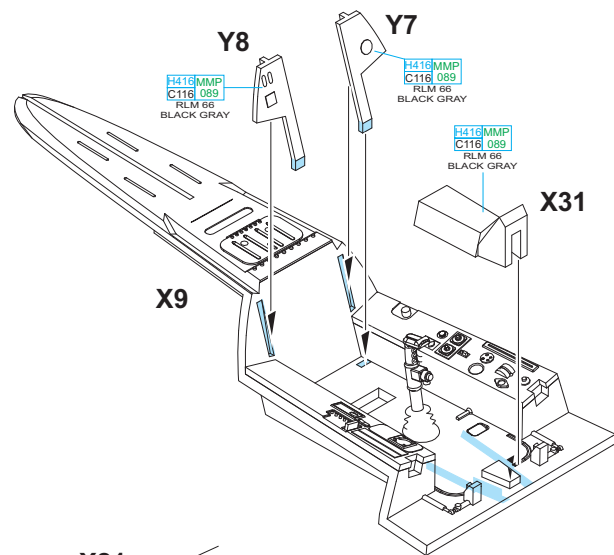
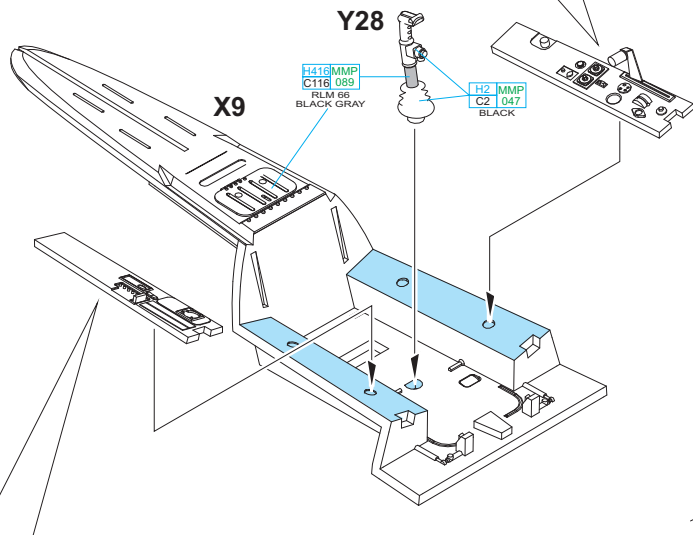
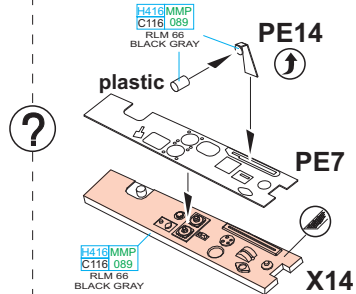
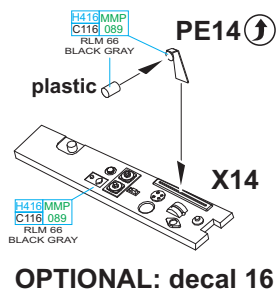
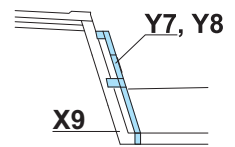

OPTIONAL: decal 15

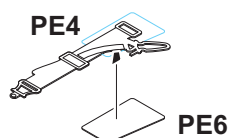
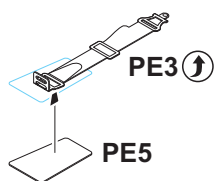
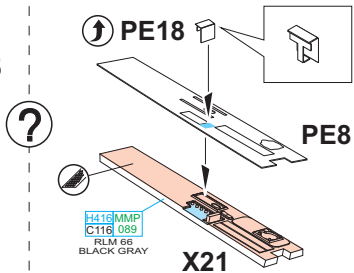
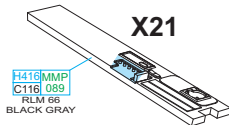

OPTIONAL: decal 17

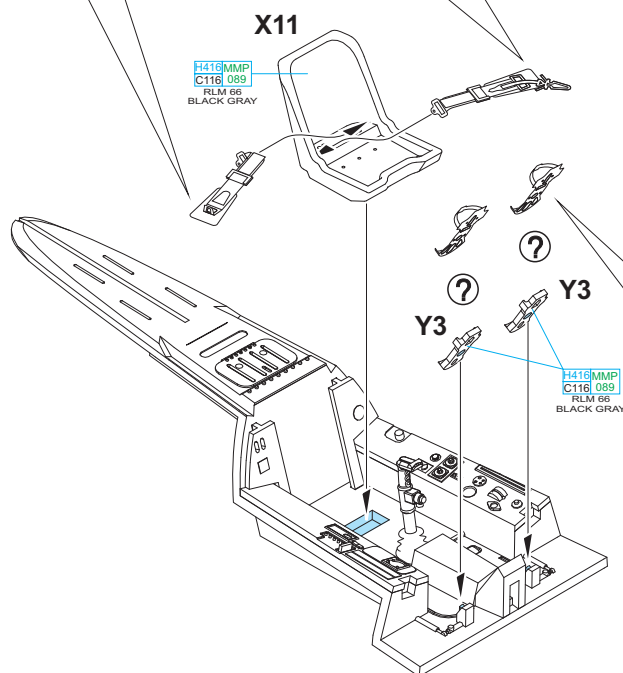
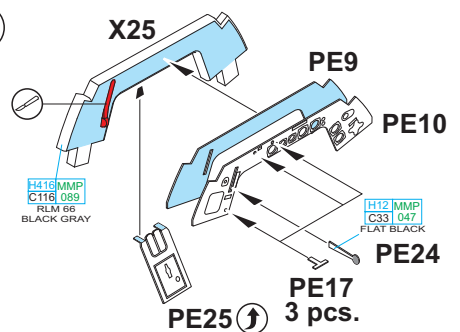
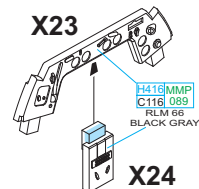

PE27 PE28

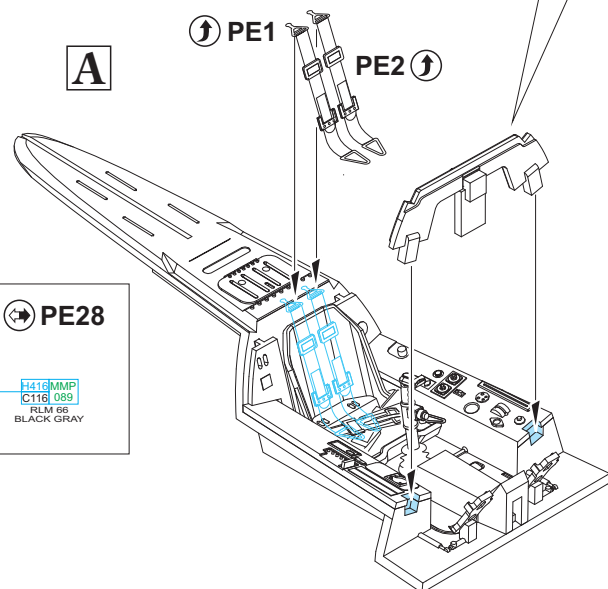
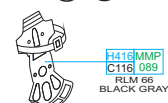

B

W23

W15

X5

X38

X46

H70 MMP
C60 056
RLM 02
GRAY

W27

H70 MMP
C60 056
RLM 02
GRAY

W3

H70 MMP
C60 056
RLM 02
GRAY

W22

MC218
MMM
003
ALUMINIUM

W20

W12

MC214
MMM
001
DARK IRON

MC214
MMM
001
DARK IRON

W17

W9

MC218
MMM
003
ALUMINIUM

MC218
MMM
003
ALUMINIUM

MC218
MMM
003
ALUMINIUM

W13

H12 MMP
C33 047
FLAT BLACK

W29

MC218
MMM
003
ALUMINIUM

W31

MC218
MMM
003
ALUMINIUM

W1

MC214
MMM
001
DARK IRON

H12 MMP
C33 047
FLAT BLACK

W16

MC218
MMM
003
ALUMINIUM

R5

MC214
MMM
001
DARK IRON

W2

H12 MMP
C33 047
FLAT BLACK

MC218
MMM
003
ALUMINIUM

W28

H12 MMP
C33 047
FLAT BLACK

H413 MMP
C113 090
RLM 04
YELLOW

W4

MC218
MMM
003
ALUMINIUM

W30

W21

MC218
MMM
003
ALUMINIUM

H12 MMP
C33 047
FLAT BLACK

MC218
MMM
003
ALUMINIUM

W14

H12 MMP
C33 047
FLAT BLACK

W32

MC218
MMM
003
ALUMINIUM

W32

W21

W21

W2

W14

DON'T INSTALL PARTS W12, W20, W3 AND W27 IF YOU ARE BUILDING THE MODEL WITH THE CLOSED FUSELAGE MG HOOD (R8).
POKUD STAVÍTE MODEL SE ZAVŘENÝM KRYTEM TRUPOVÝCH KULOMETŮ (R8), NEINSTALUJTE DÍLY W12, W20, W3 A W27

**DON'T INSTALL PARTS W12, W20, W3 AND W27
IF YOU ARE BUILDING THE MODEL WITH
THE CLOSED FUSELAGE MG HOOD (R8).
POKUD STAVÍTE MODEL SE ZAVŘENÝM
KRYTEM TRUPOVÝCH KULOMETŮ (R8),
NEINSTALUJTE DÍLY W12, W20, W3 A W27**

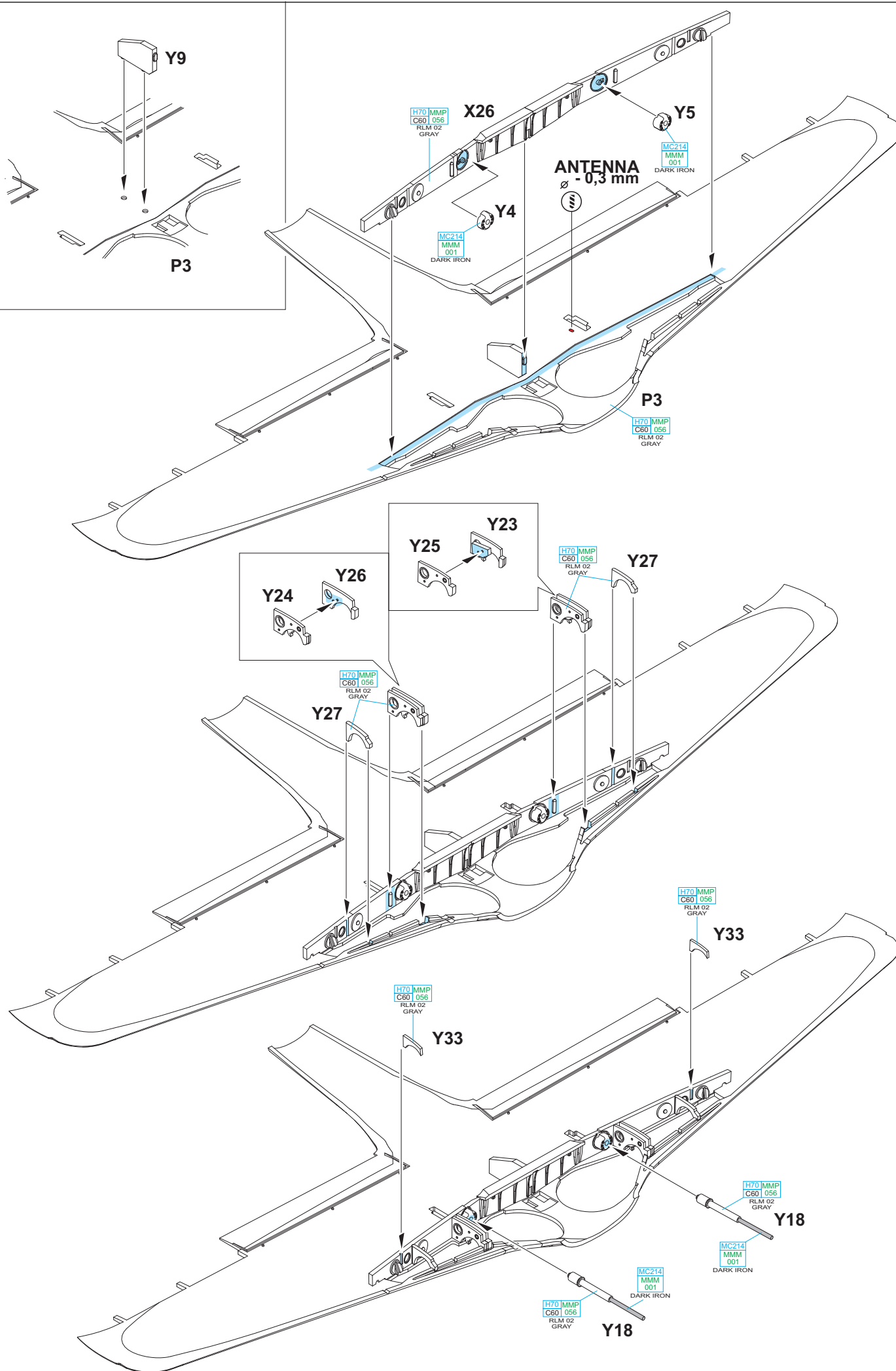

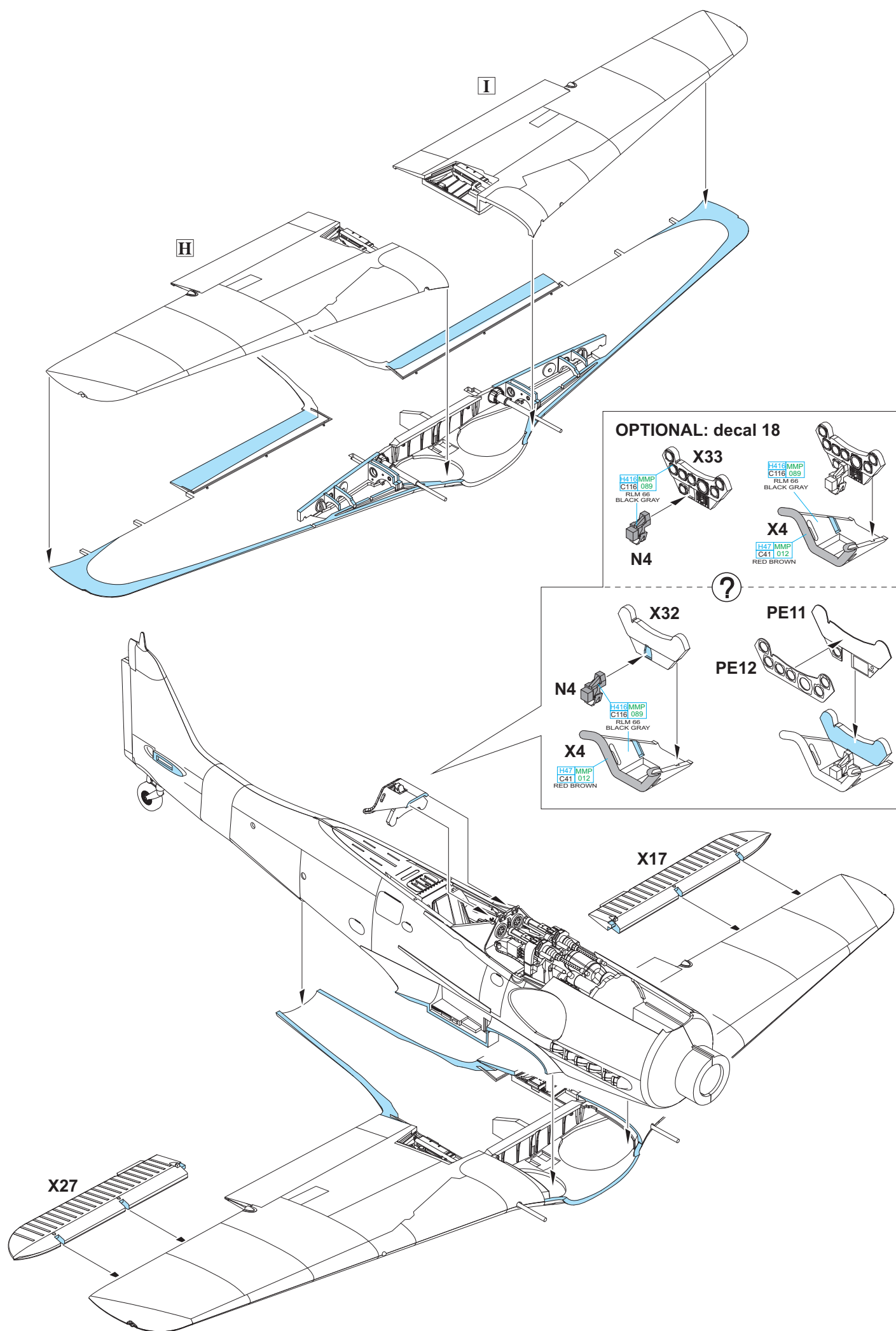

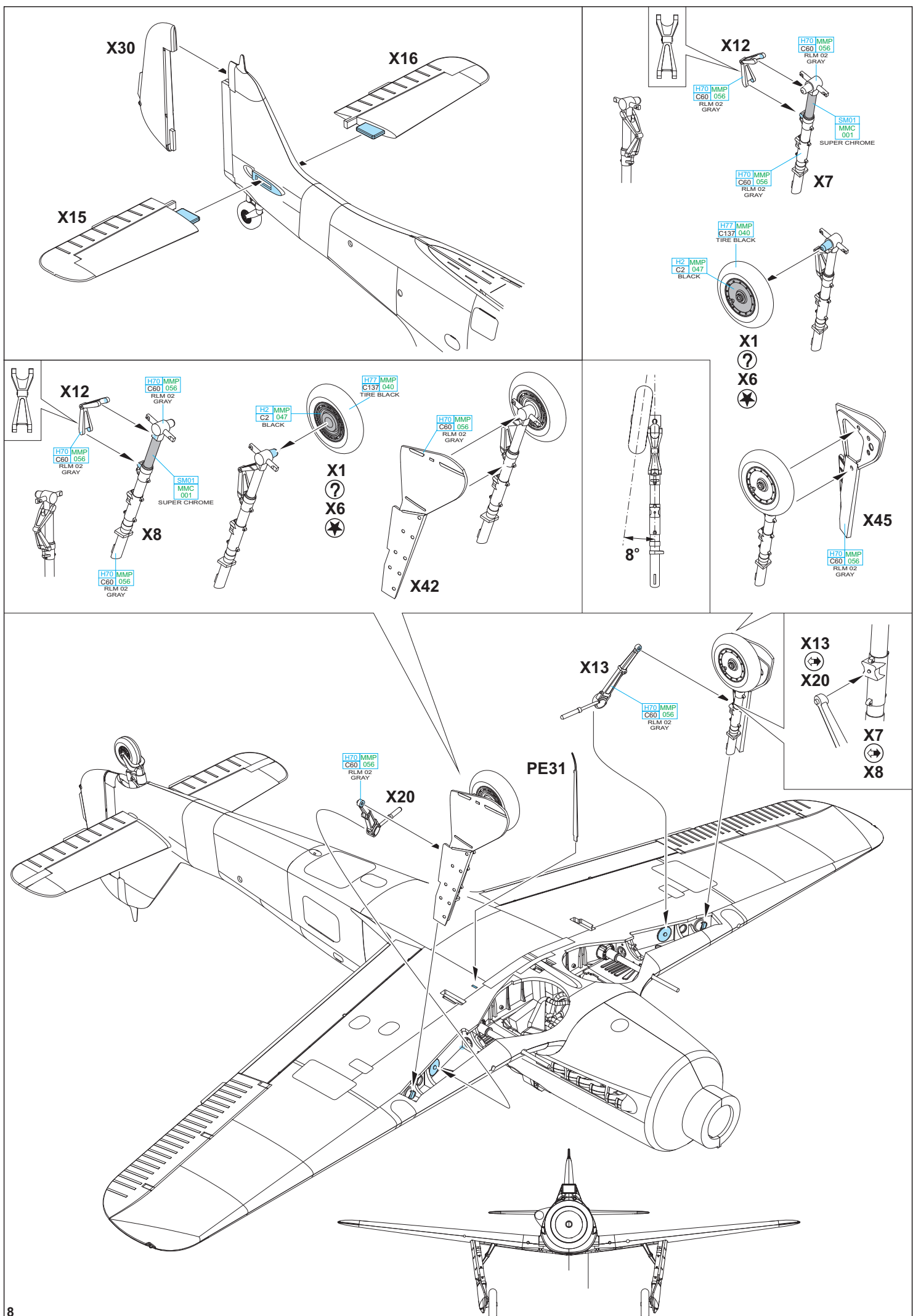

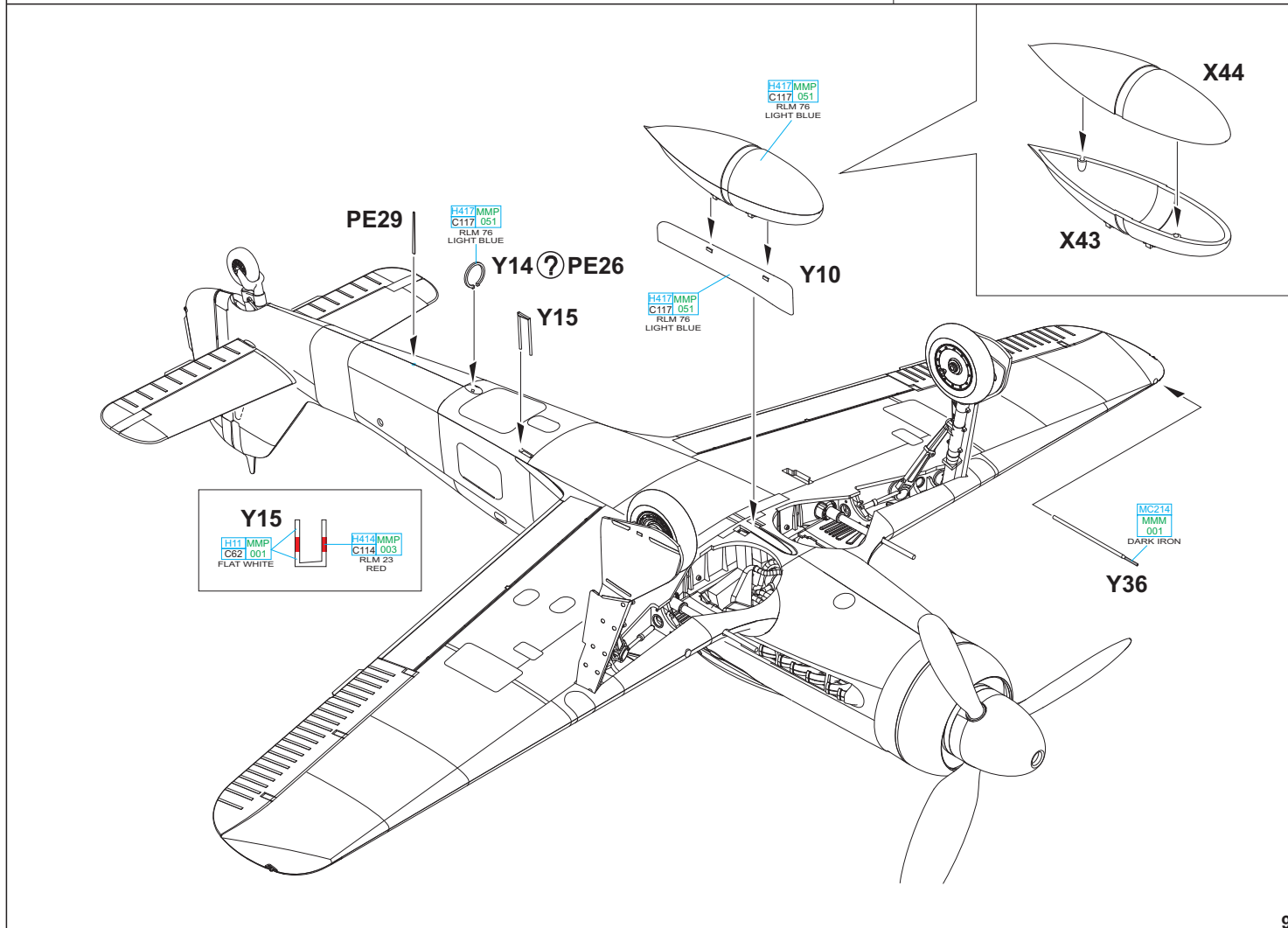
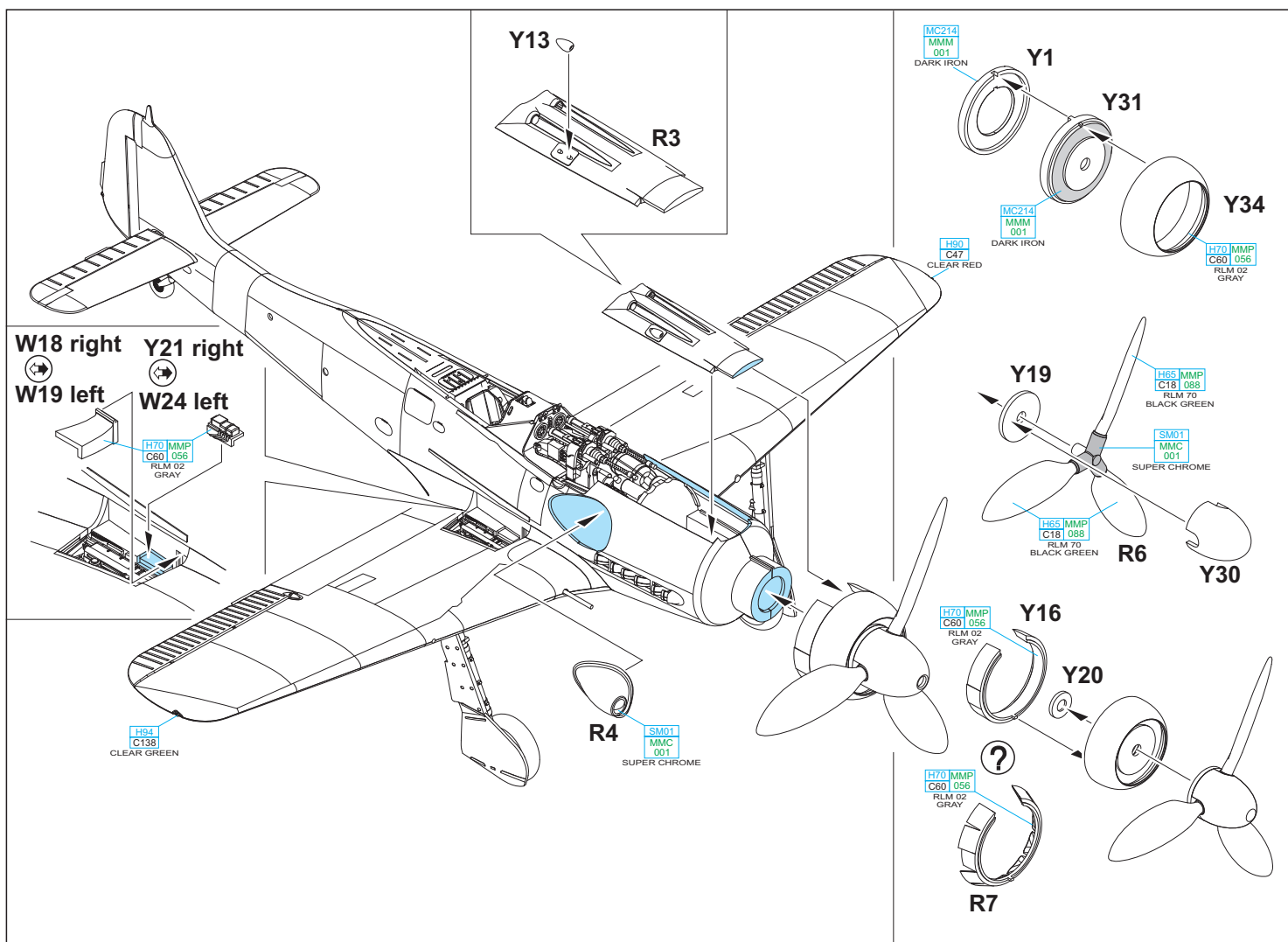

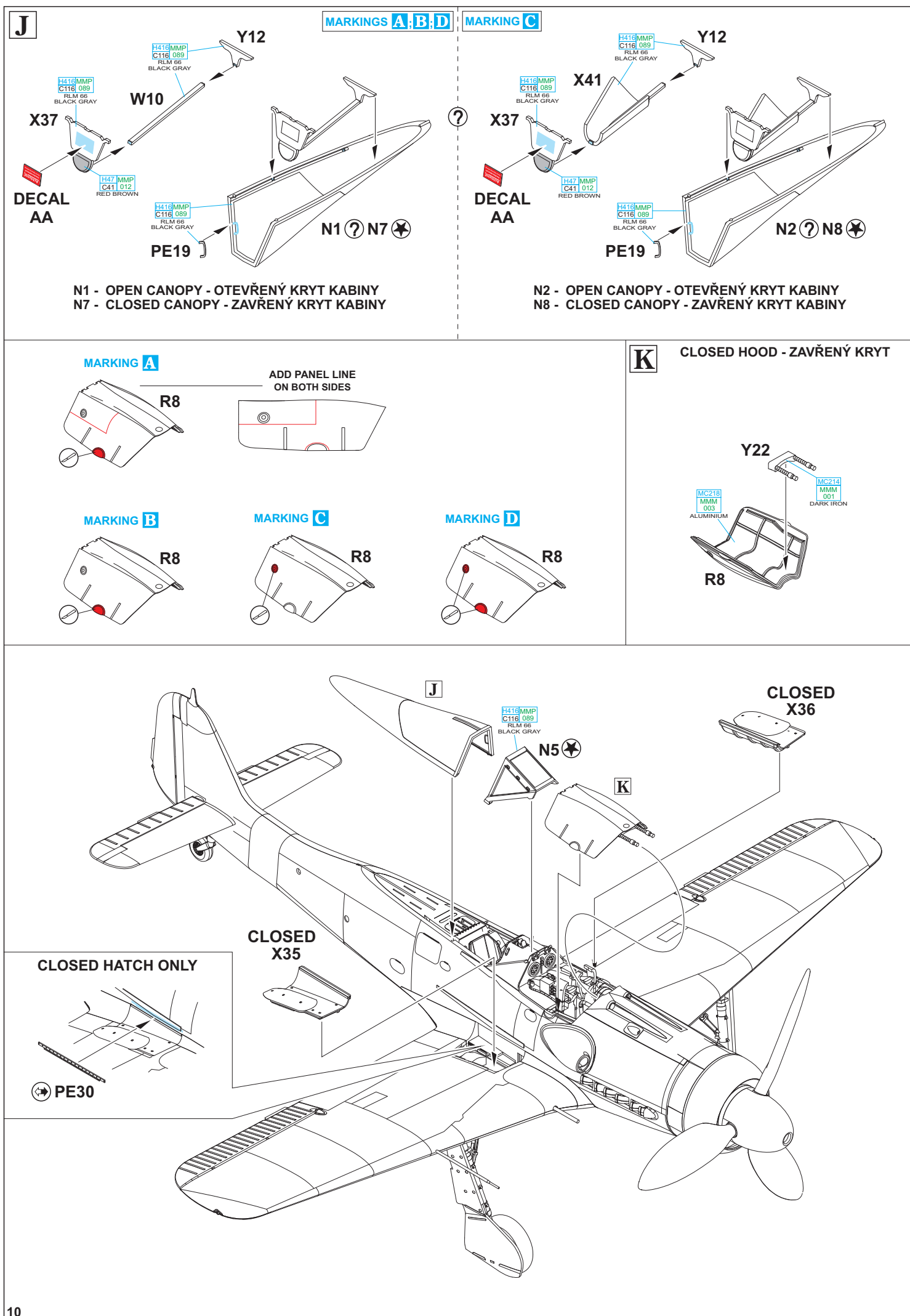

CLOSED HATCH ONLY

PE30

?

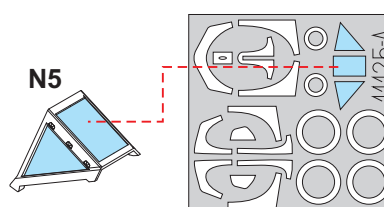
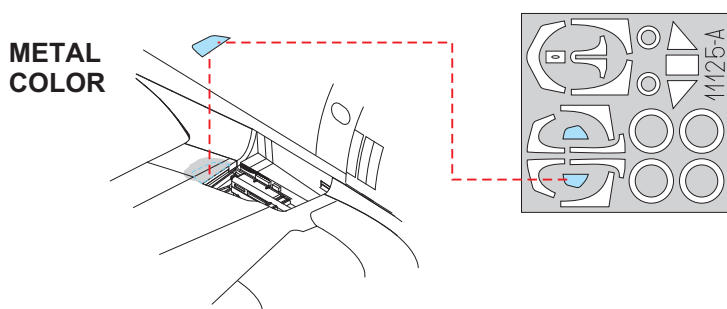
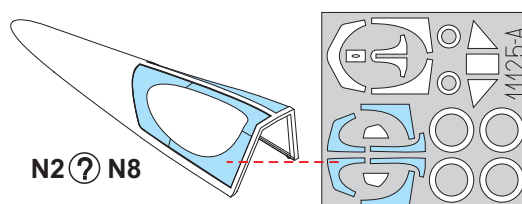
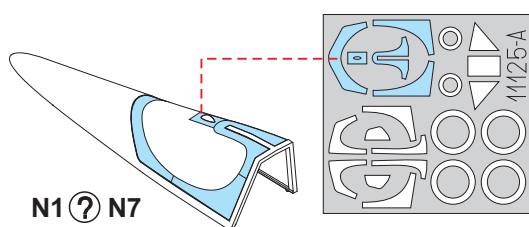
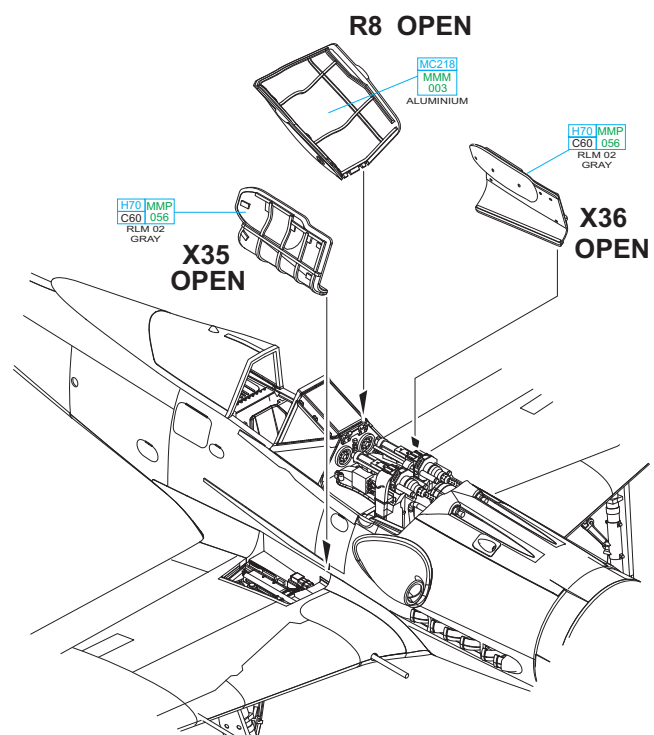

CAMOUFLAGE
COLOR

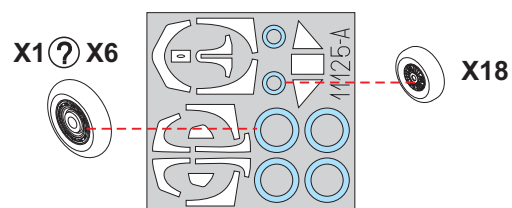
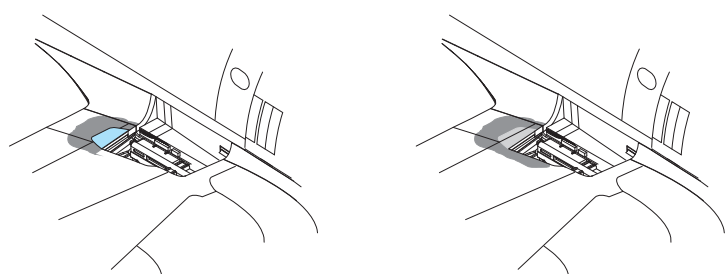

ATTENTION



UPOZORNĚNÍ



ACHTUNG



ATTENTION



注意



Carefully read instruction sheet before assembling. When you use glue or paint, do not use near open flame and use in well ventilated room. Keep out of reach of small children. Children must not be allowed to suck any part, or pull vinyl bag over the head.



Před započatím stavby si pečlivě prostudujte stavební návod. Při používání barev a lepidel pracujte v dobře větrané místnosti. Lepidla ani barvy nepoužívejte v blízkosti otevřeného ohně. Model není určen malým dětem, mohlo by dojít k požití drobných dílů.

INSTRUCTION SIGNS

INSTR. SYMBOLY

INSTRUKTION SINNBILDEN

SYMBOLES

記号の説明



OPTIONAL
VOLBA



BEND
OHNOUT



OPEN HOLE
VYVRTAT OTVOR



SYMETRICAL ASSEMBLY
SYMETRICKÁ MONTÁŽ



REMOVE
ODŘÍZNOUT



REVERSE SIDE
OTOČIT



APPLY EDUARD MASK
AND PAINT
POUŽÍT EDUARD MASK
NABARVIT

PARTS



DÍLY



TEILE



PIÈCES



部品

PLASTIC PARTS

H>

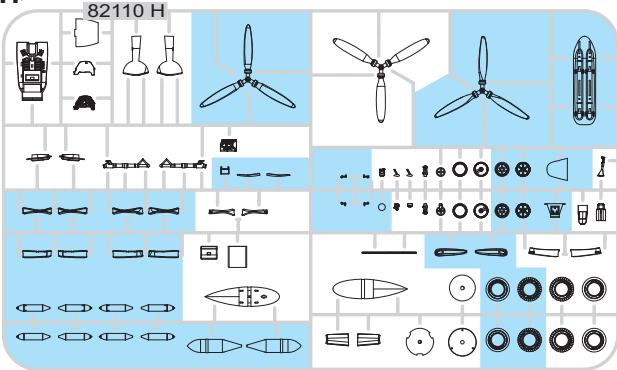

I>

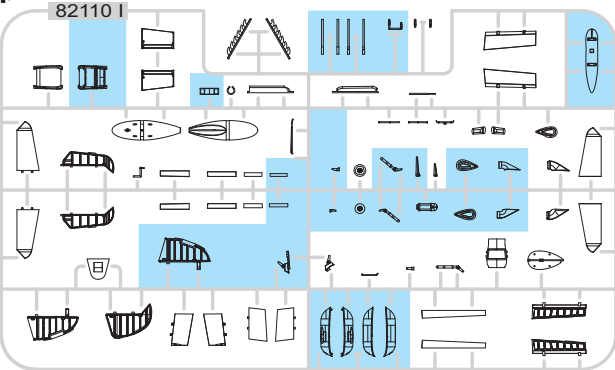

J>

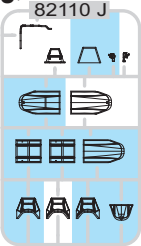

T>

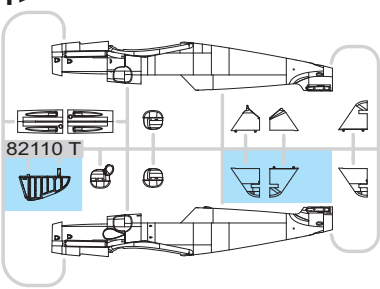

N>

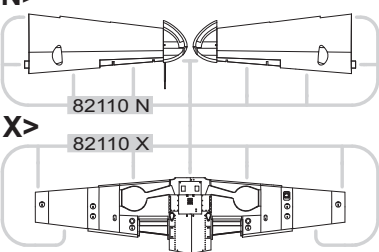

X>

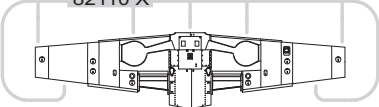

V>

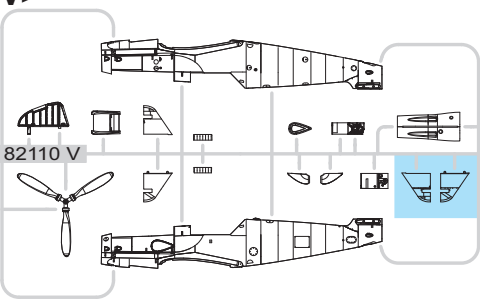

U>

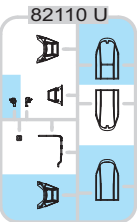

PE - PHOTO ETCHED DETAIL PARTS

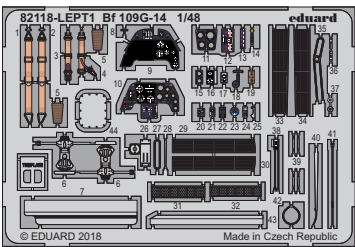

-Parts not for use. -Teile werden nicht verwendet. -Pièces à ne pas utiliser. -Tyto díly nepoužívejte při stavbě. - 使用しない部品

COLOURS



BARVY



FARBEN



PEINTURE



色

GSI Creos (GUNZE)		MISSION MODELS
AQUEOUS	Mr.COLOR	PAINTS
H2	C2	MMP-047
H5	C5	MMP-048
H11	C62	MMP-001
H12	C33	MMP-047
H47	C41	MMP-012
H65	C18	MMP-088
H68	C36	MMP-049
H69	C37	MMP-050
H70	C60	MMP-056
H77	C137	MMP-040
H90	C47	
		BLACK
		BLUE
		FLAT WHITE
		FLAT BLACK
		RED BROWN
		RLM70 BLACK GREEN
		RLM74 DARK GRAY
		RLM75 GRAY
		RLM02 GRAY
		TIRE BLACK
		CLEAR RED

GSI Creos (GUNZE)		MISSION MODELS
AQUEOUS	Mr.COLOR	PAINTS
H94	C138	
H413	C113	MMP-090
H414	C114	
H416	C116	MMP-089
H417	C117	MMP-051
		CLEAR GREEN
		RLM04 YELLOW
		RLM23 RED
		RLM66 BLACK GRAY
		RLM76 LIGHT BLUE
Mr.METAL COLOR		METALLICS
MC213		MMM-006
MC214		MMM-001
Mr.COLOR SUPER METALLIC		METALLICS
SM01		MMC-001
		STEEL
		DARK IRON
		SUPER CHROME

Bf 109G-14 - 14/AS

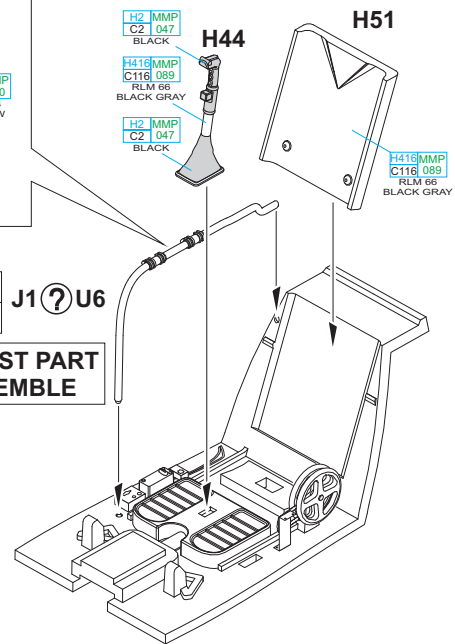
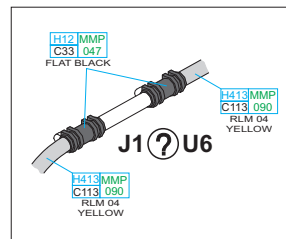
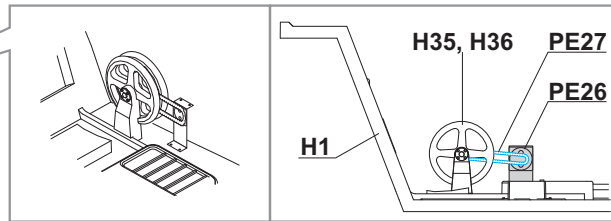
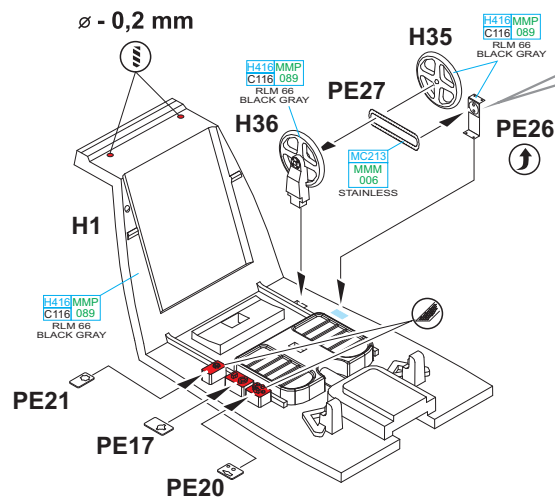

J1 - MARKINGS E, F
U6 - MARKINGS G, H

J1 ? U6

THE LATEST PART TO ASSEMBLE

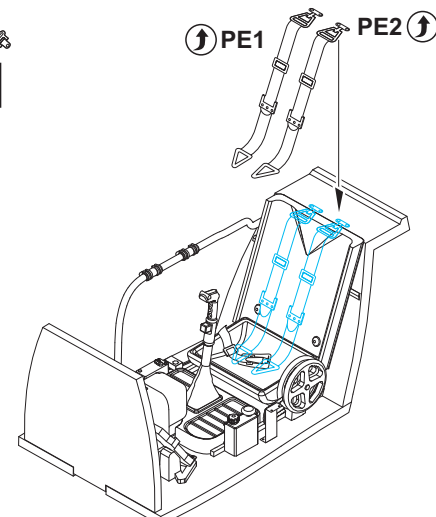
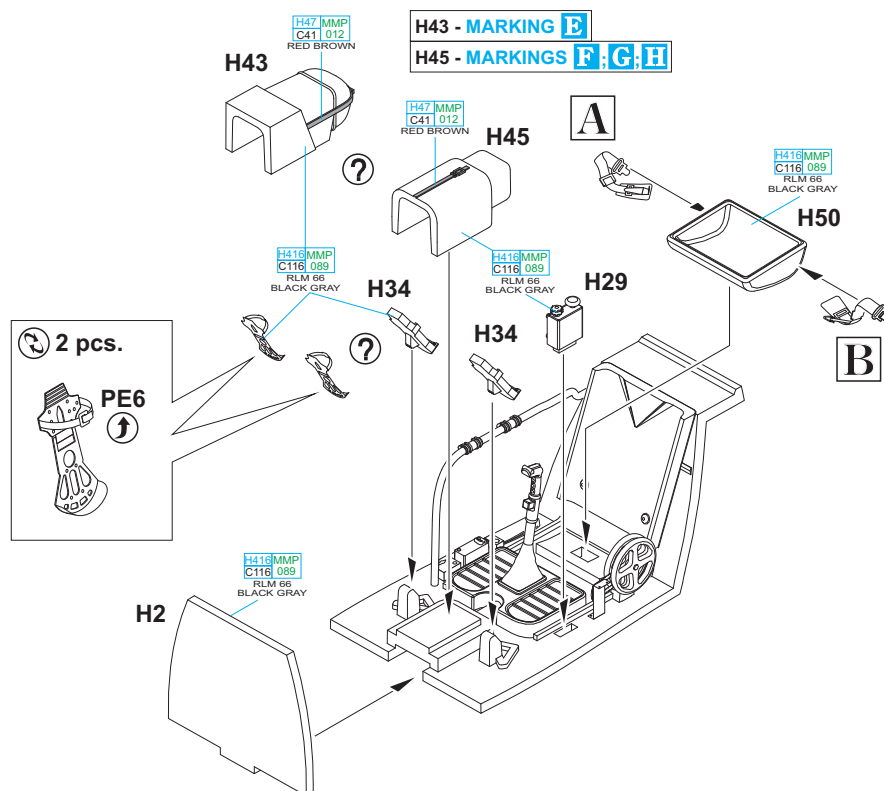
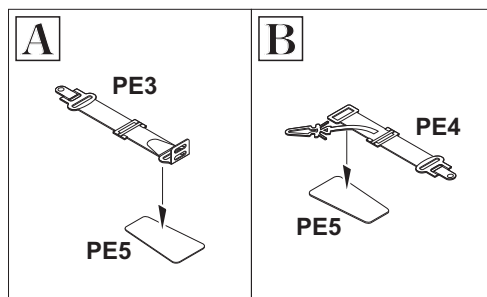

Bf 109G-14

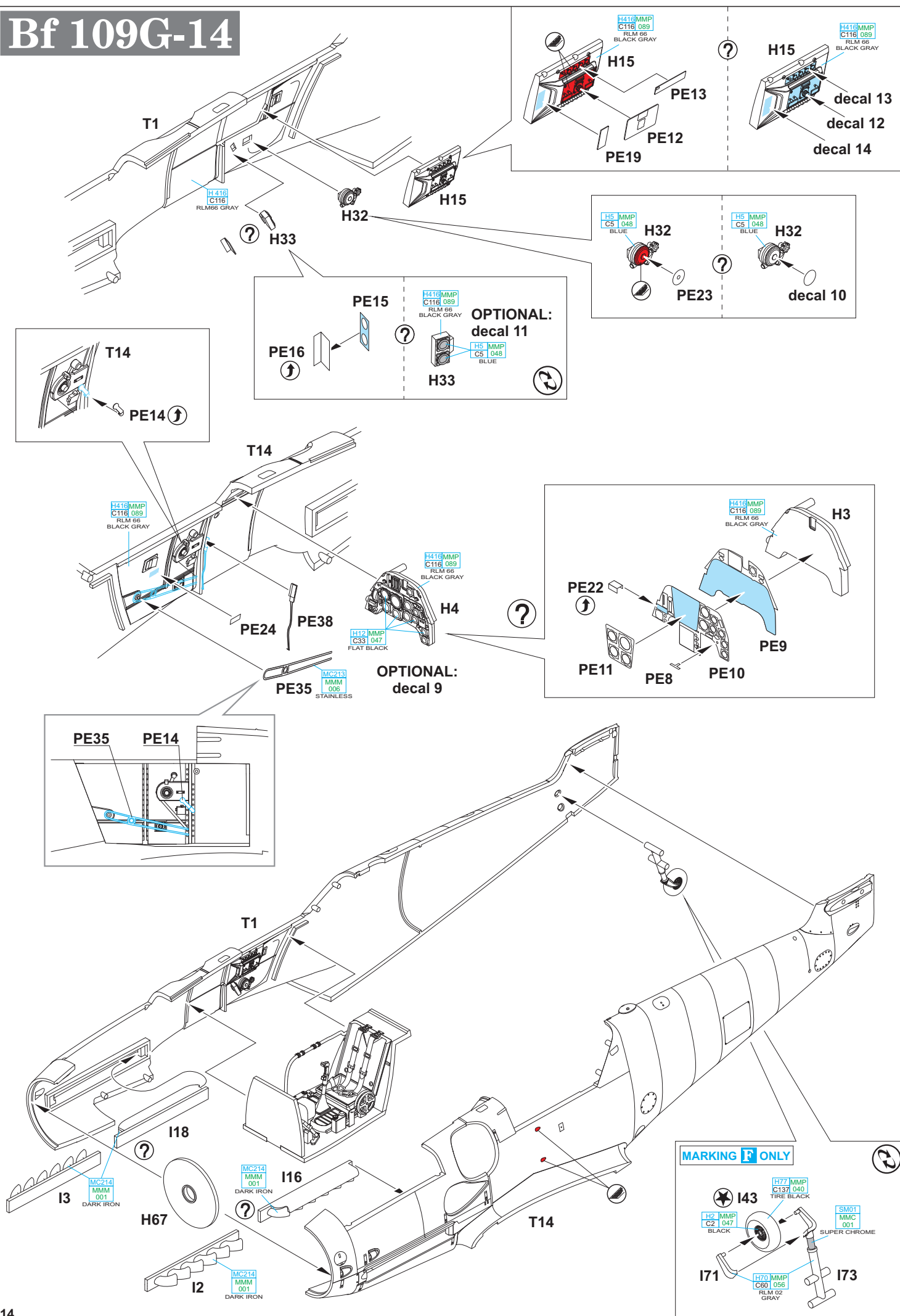

Bf 109G-14/AS

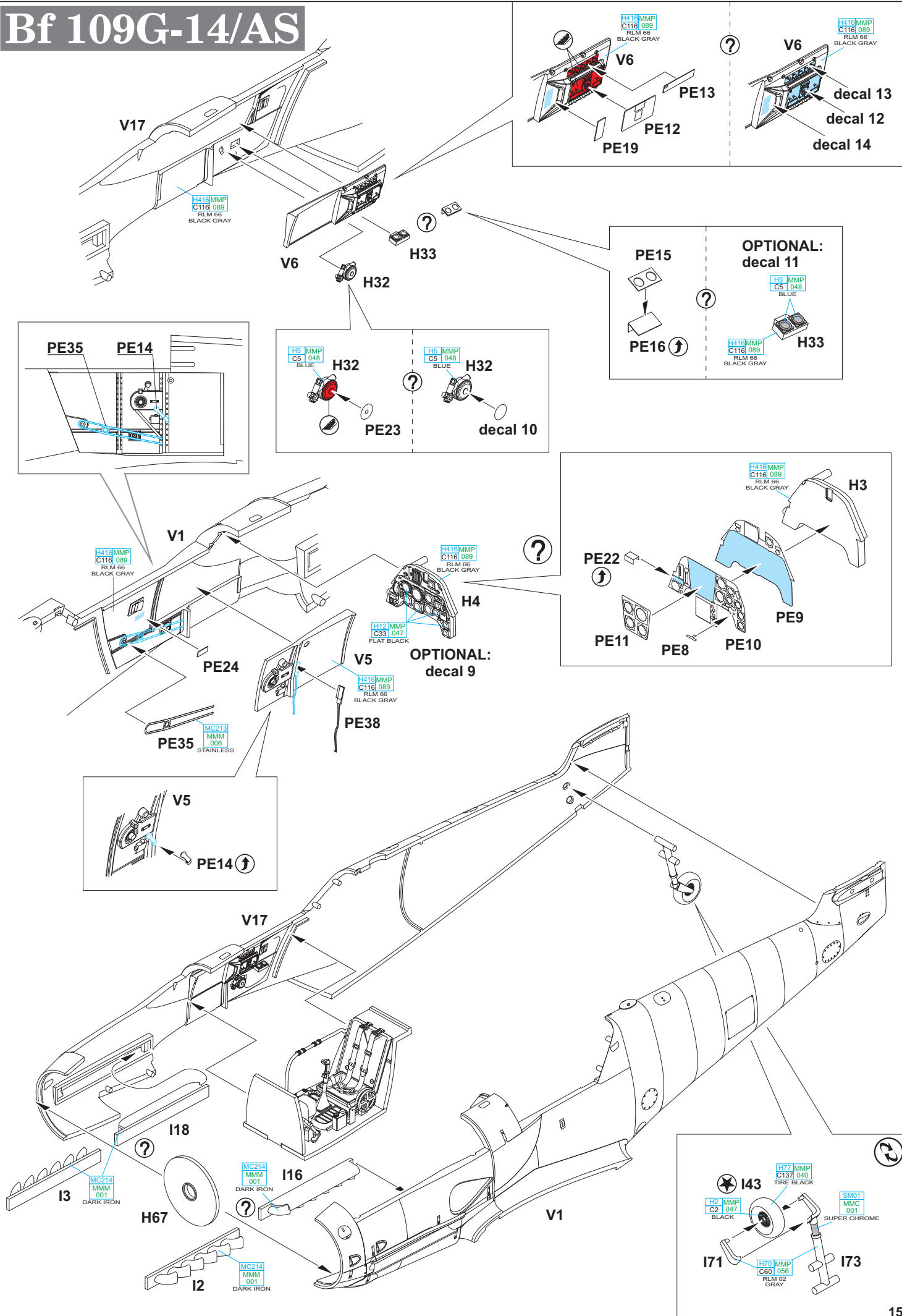

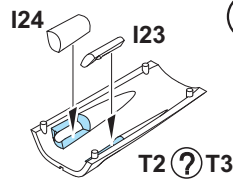

T2 ? T3

T2 - MARKING E

T3 - MARKING F

T5 - MARKING E

T5 ? T6

T6 - MARKING F

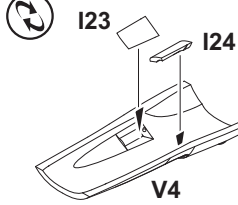
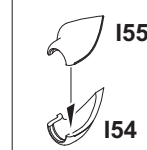
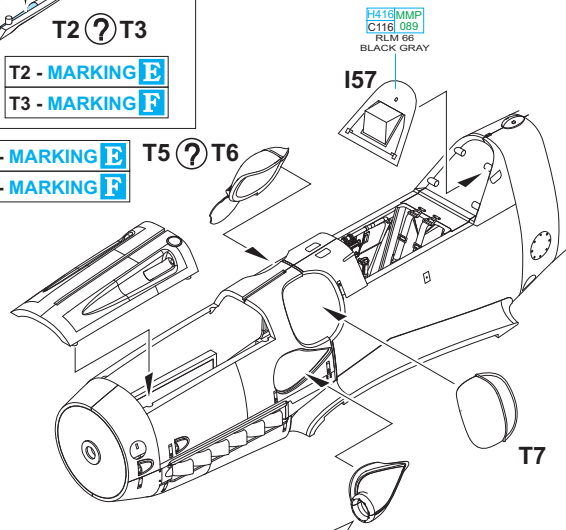

V4

I57

H41C MMP
C116 089
RLM 66
BLACK GRAY

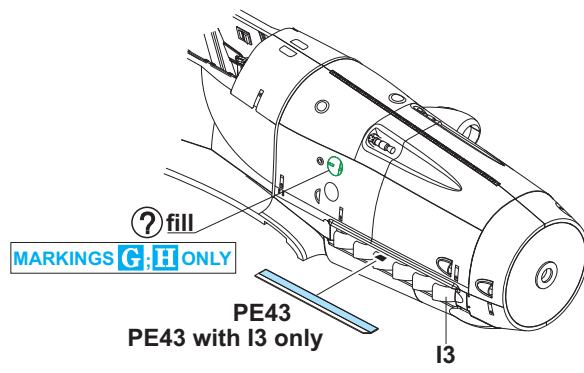
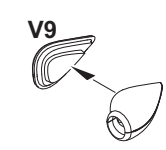
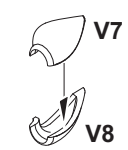
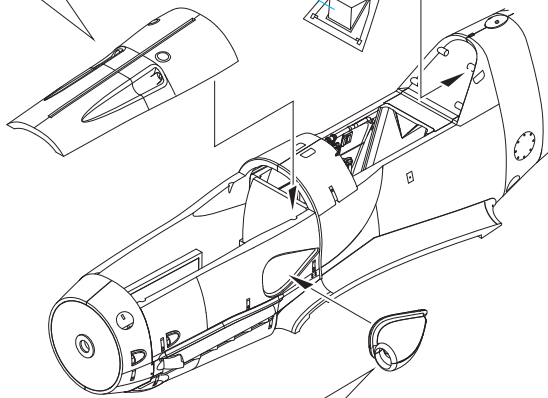

? fill
MARKINGS G,H ONLY

PE43
PE43 with I3 only

I3

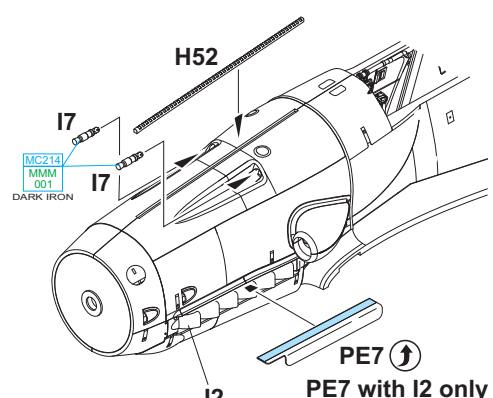

H52

I7
MC214
MMM
001
DARK IRON

I2

PE7
PE7 with I2 only

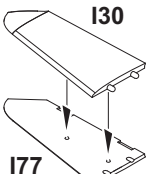

I77

MARKING E

MARKING F

MARKINGS G,H

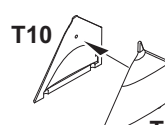

T10

T8

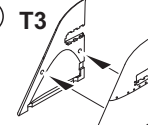

T3

T12

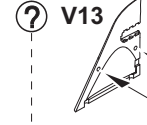

V13

V12

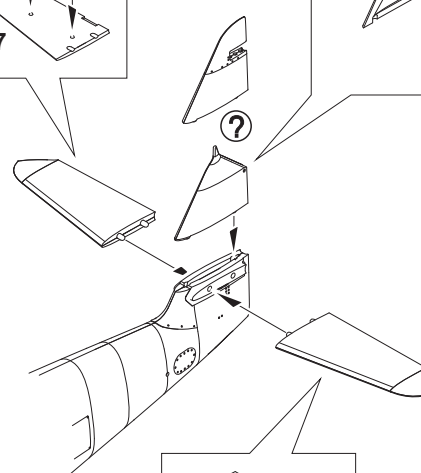

I29

I28

I58 - MARKING E

I56 - MARKING F

V12 - MARKINGS G,H

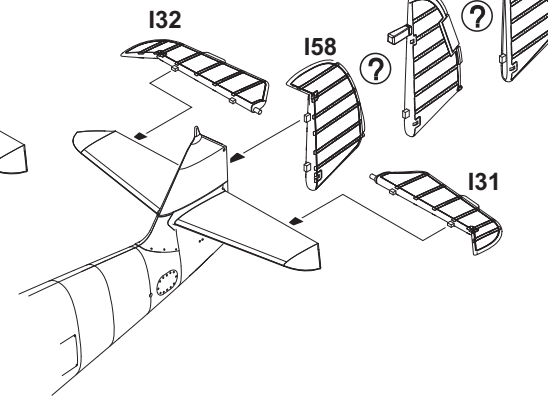

I32

I58

I56

V16

I31

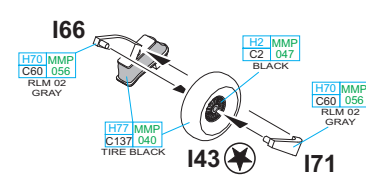

I66

H70 MMP
C60 056
RLM 02
GRAY

H77 MMP
C137 040
TIRE BLACK

H2 MMP
C2 047
BLACK

H70 MMP
C60 056
RLM 02
GRAY

I43

I71

MARKING E ONLY

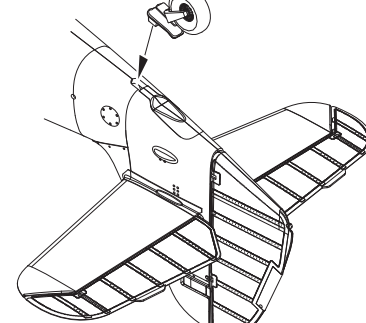

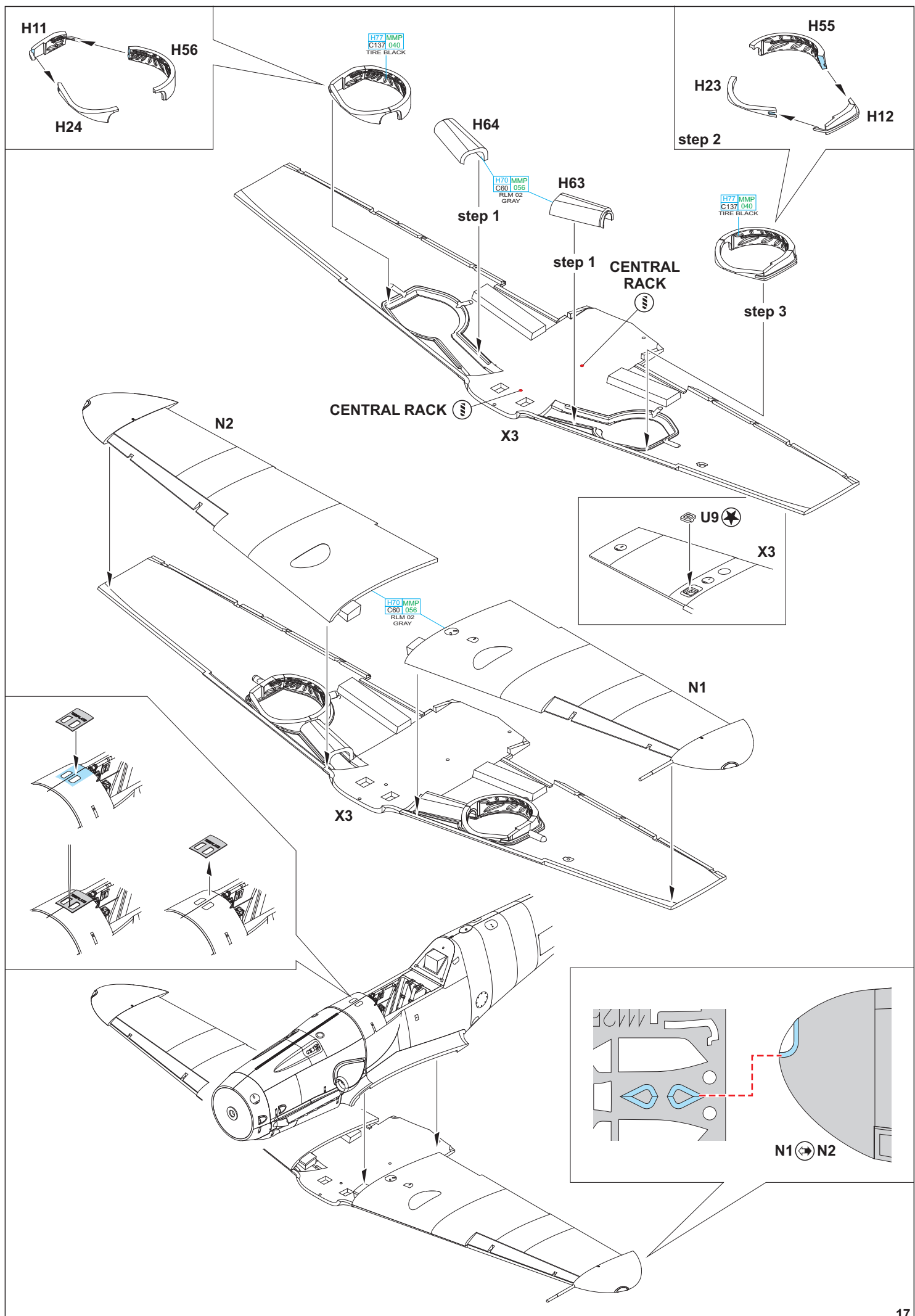

**CORRECT POSITION
OF RADIATOR FLAPS**

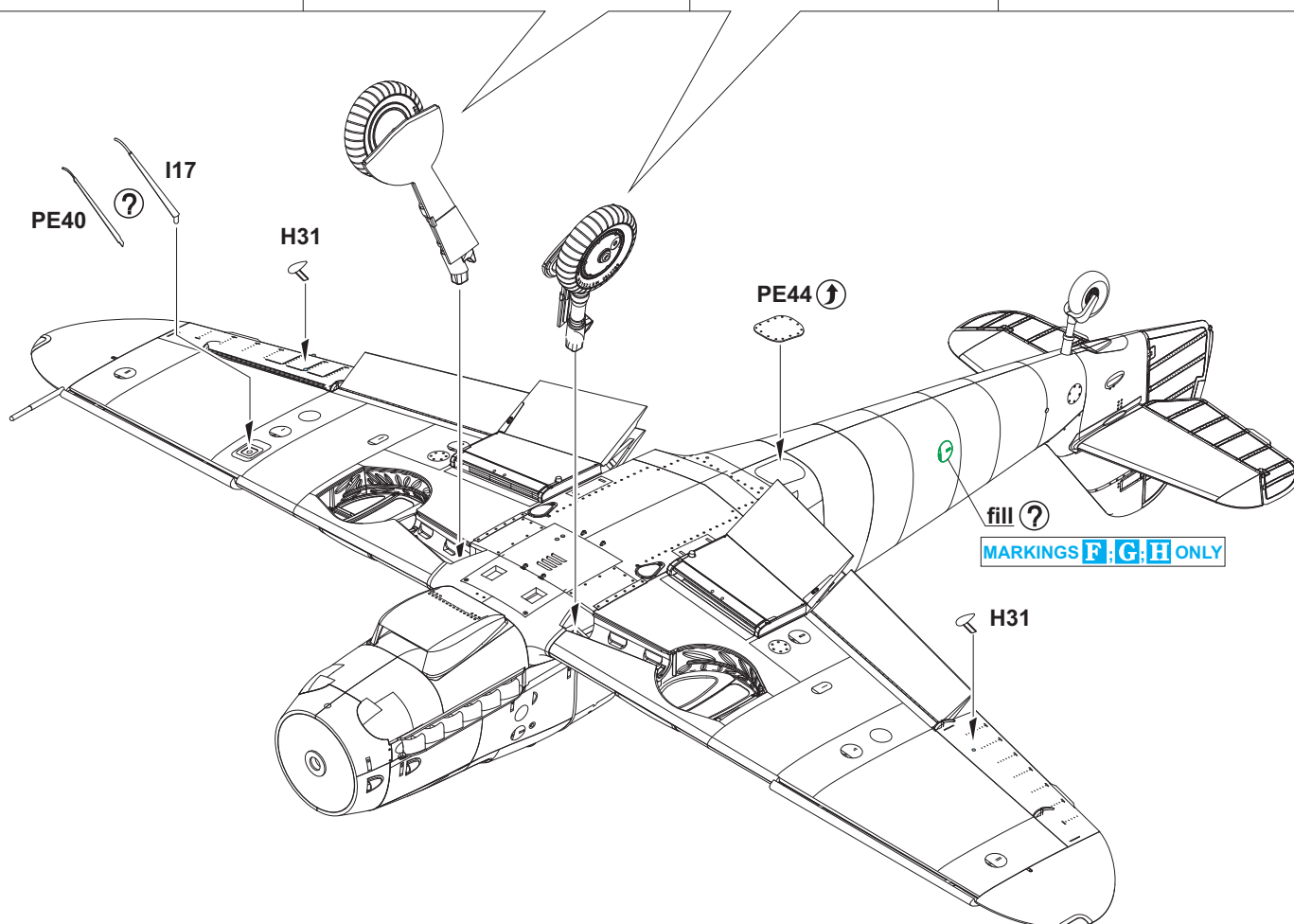
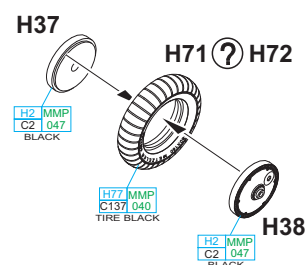
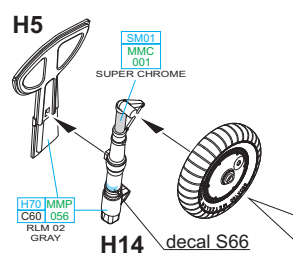
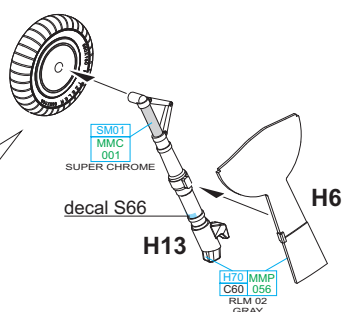
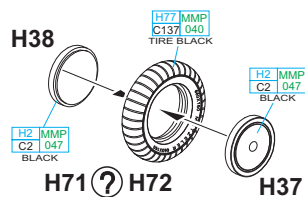
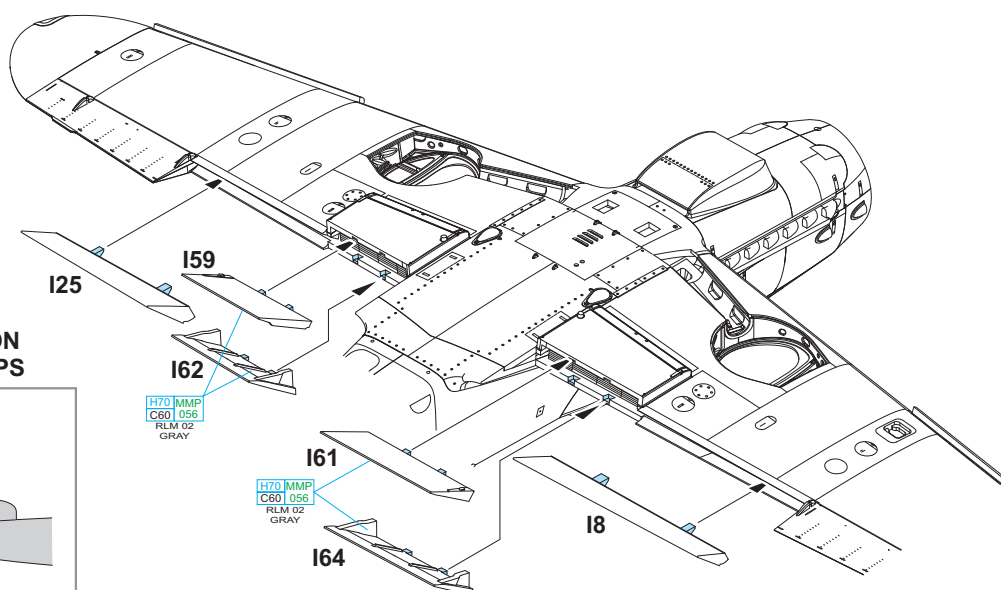
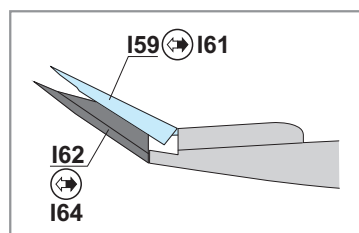

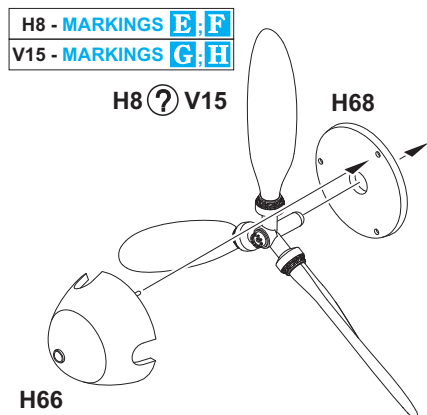
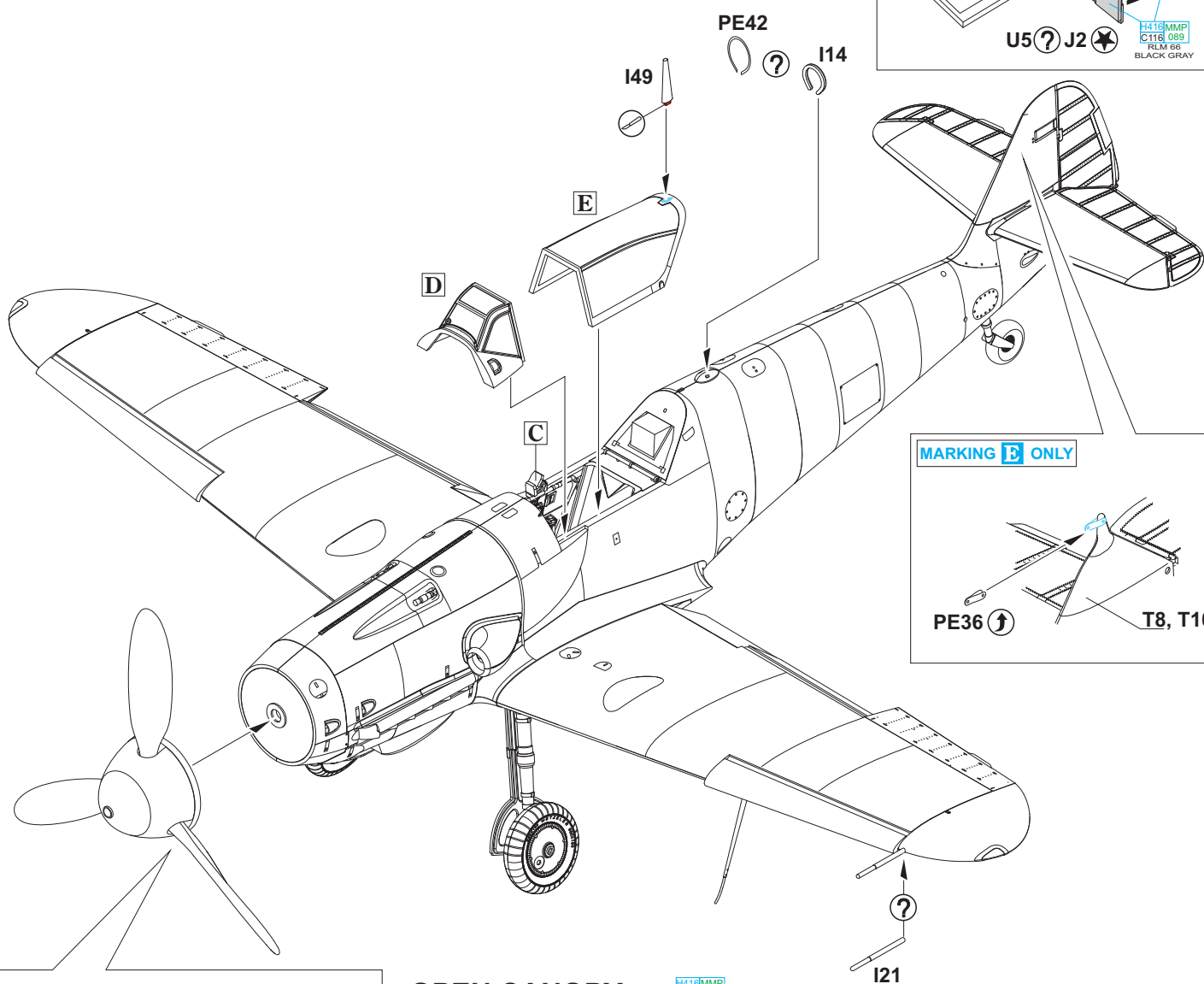
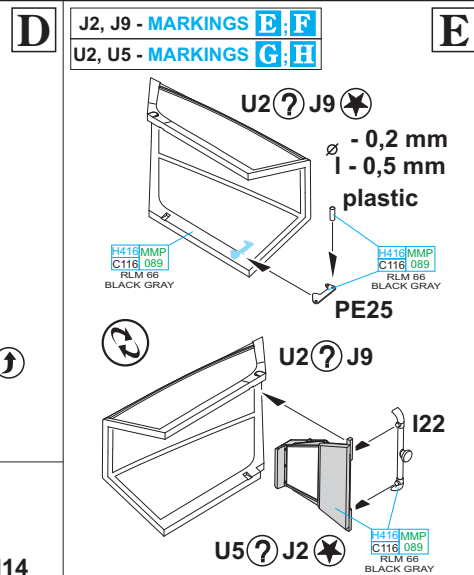
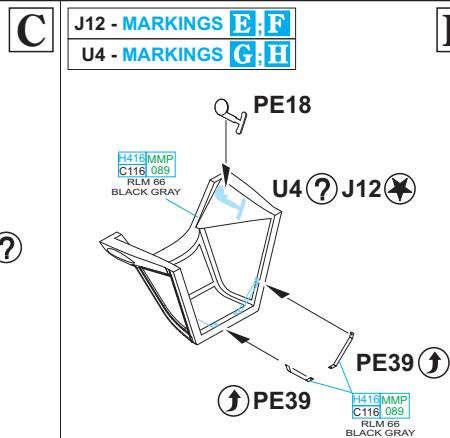
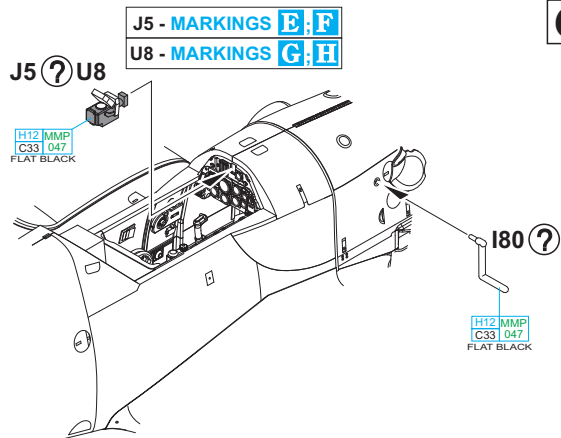

OPEN CANOPY

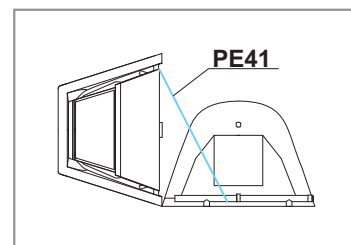
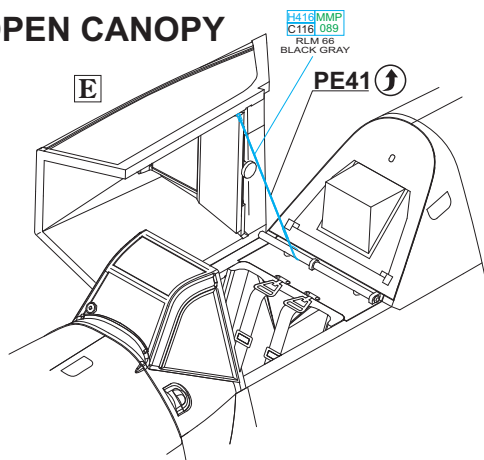

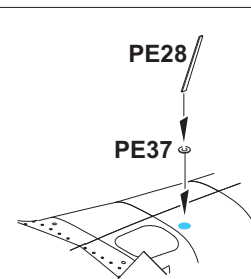
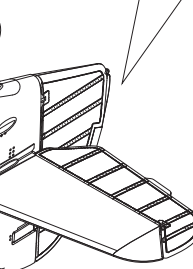
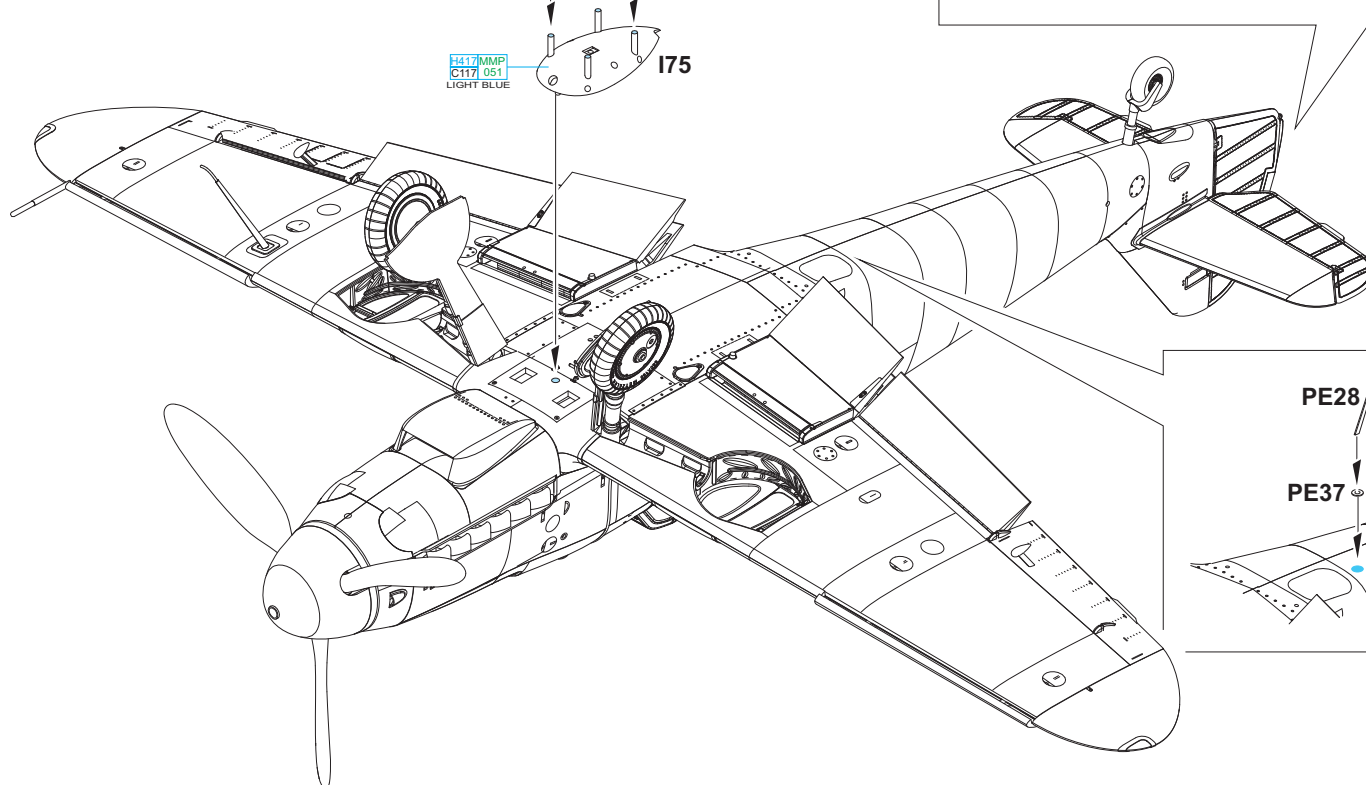
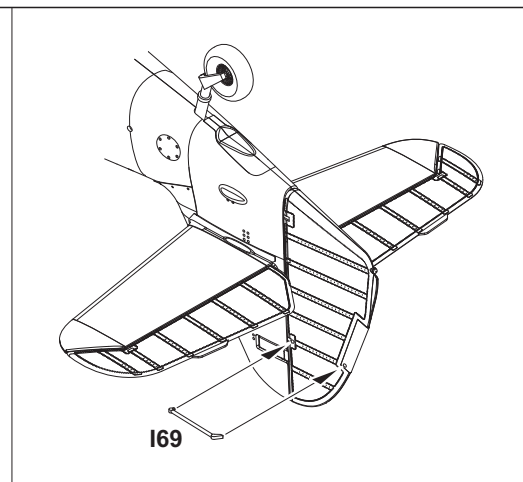
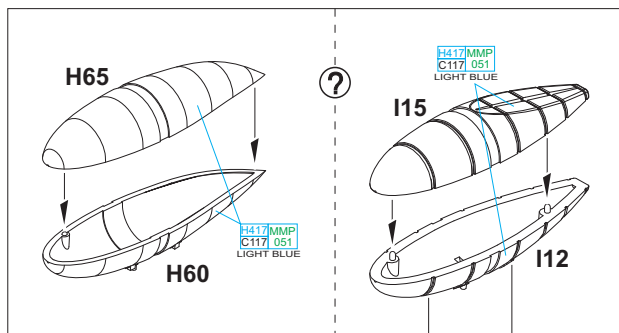

eduard
MASK
11125-B

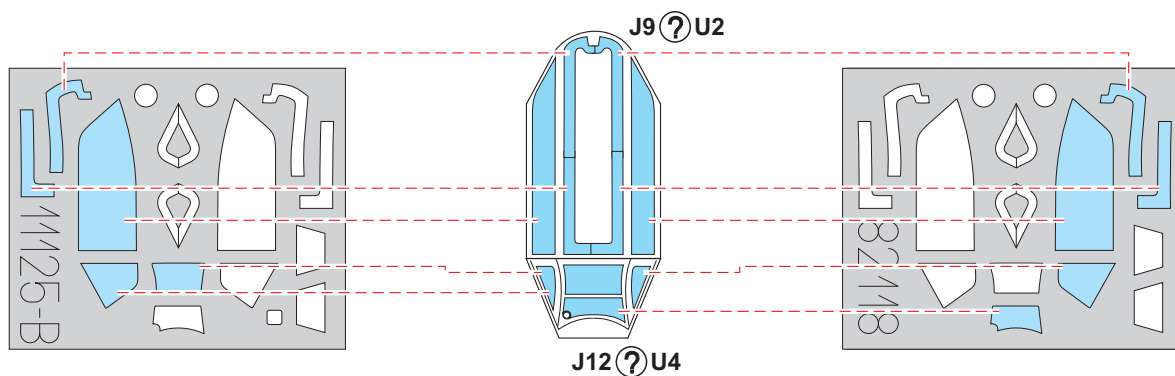
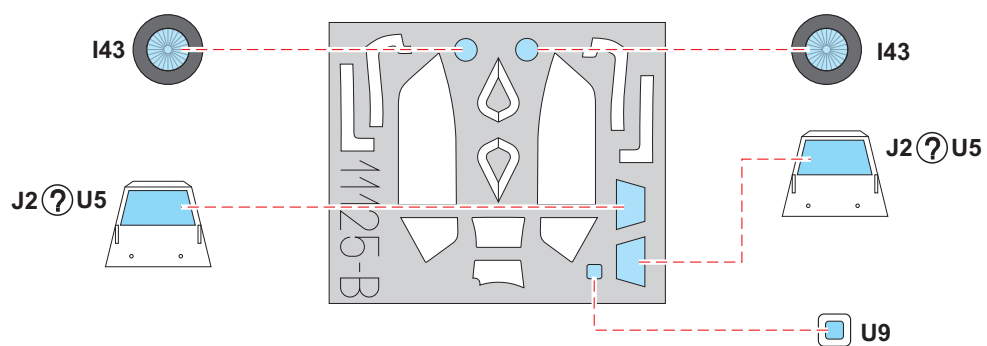

A

Having reached the target area, Grimbergen airport, Lt. Nibel picked his target which was a twin-engine airplane parked on the apron. Pressing his attack on the light flak post his engine seized and Lt. Nibel performed the emergency belly-landing nearby the village of Wommel. He was captured after the landing. The reason of the engine seizure was a collision with a bird! The fuselage sports a typical Sorau factory camouflage in RLM 75/83/76, wings were delivered (or over-sprayed at the unit level) in RLM 82/83. The spiral was painted only on the front part of the propeller spinner.

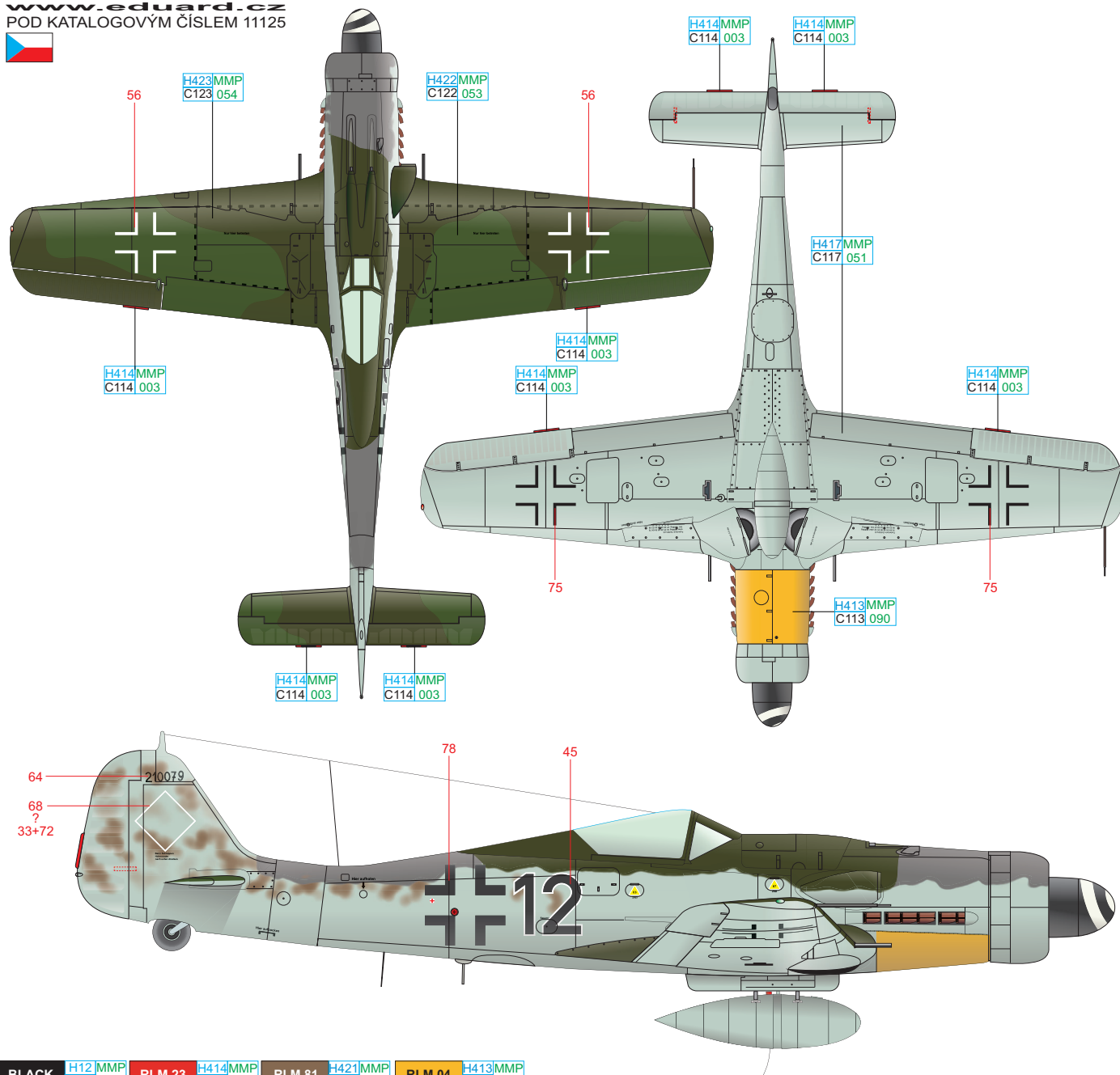
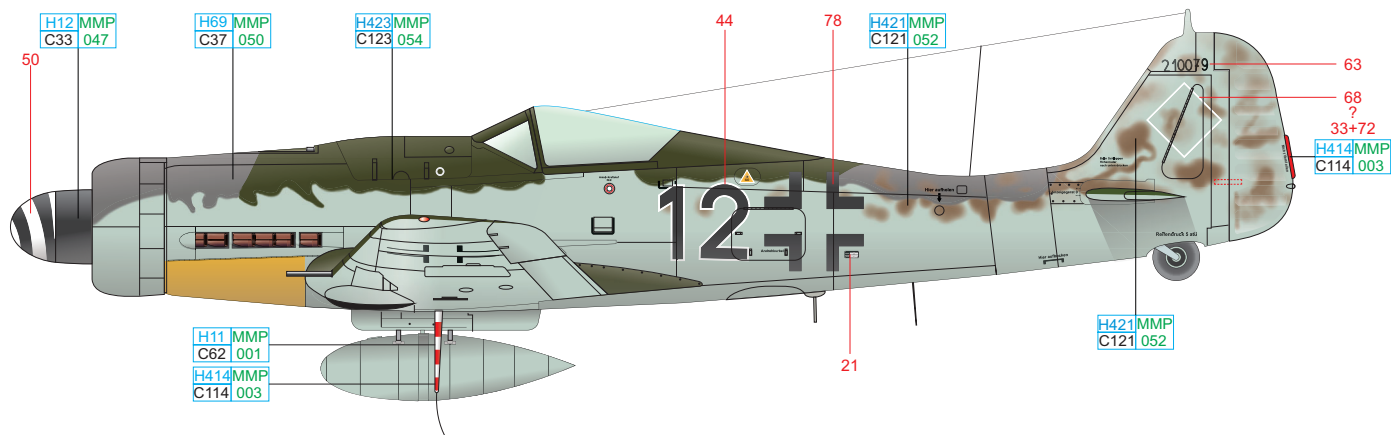

BLACK	H12 C33	MMP 047	RDM 23	H414 C114	MMP 003	RLM 81	H421 C121	MMP 052	RLM 04	H413 C113	MMP 090
RLM 75	H69 C37	MMP 050	RLM 83	H423 C123	MMP 054	RLM 82	H422 C122	MMP 053	RLM 76	H417 C117	MMP 051
									WHITE	H11 C62	MMP 001

eduard

B Fw 190D-9, W. Nr.210194, Fw. Werner Hohenberg, Stab I./JG 2, Merzhausen, Germany January 1st, 1945

Fw. Werner Hohenberg, flying in the ranks of the I./JG 2 commander Franz Hrdlicka staff flight, took part in the raid on St. Trond airport during which his plane suffered hits in the tail surfaces. During the return flight the engine of his aircraft was hit by the anti-aircraft gun projectiles. At 9:35 he force-landed at Dorff village and spent the rest of the war in captivity. Shooting down of his airplane was credited to the B Battery of the 430th AAA Batalion. Hohenberg's Dora was camouflaged in the same way as the aircraft W. Nr. 210079. The wings were spray-painted in the same colors as the fuselage – RLM 75/83. Stripes on the rear fuselage indicate JG 2 deployment in the Reich Defense role.

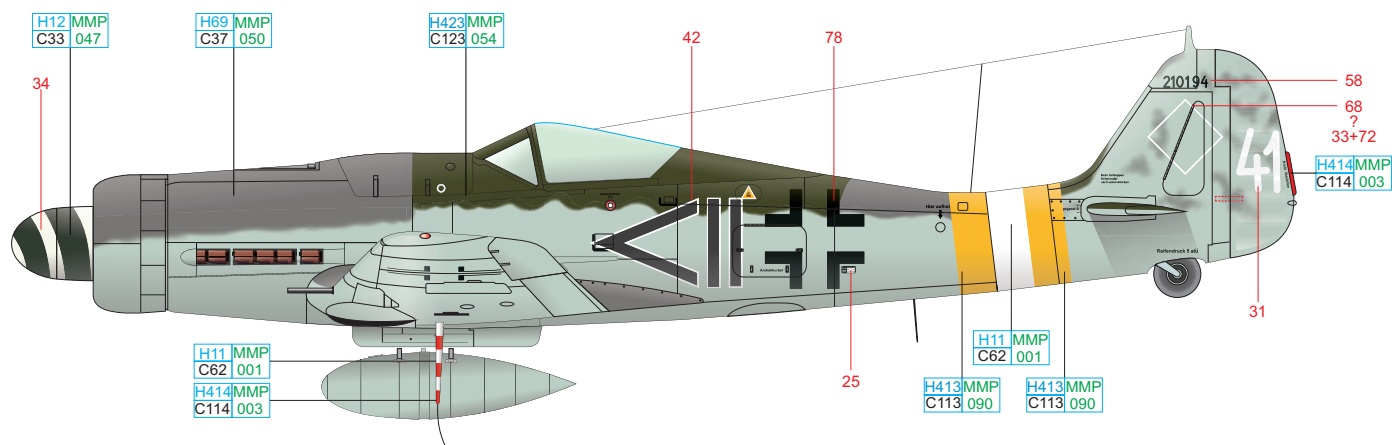

ČESKOU VERZI TEXTU NALEZNETE NA
www.eduard.cz
POD KATALOGOVÝM ČÍSLEM 11125

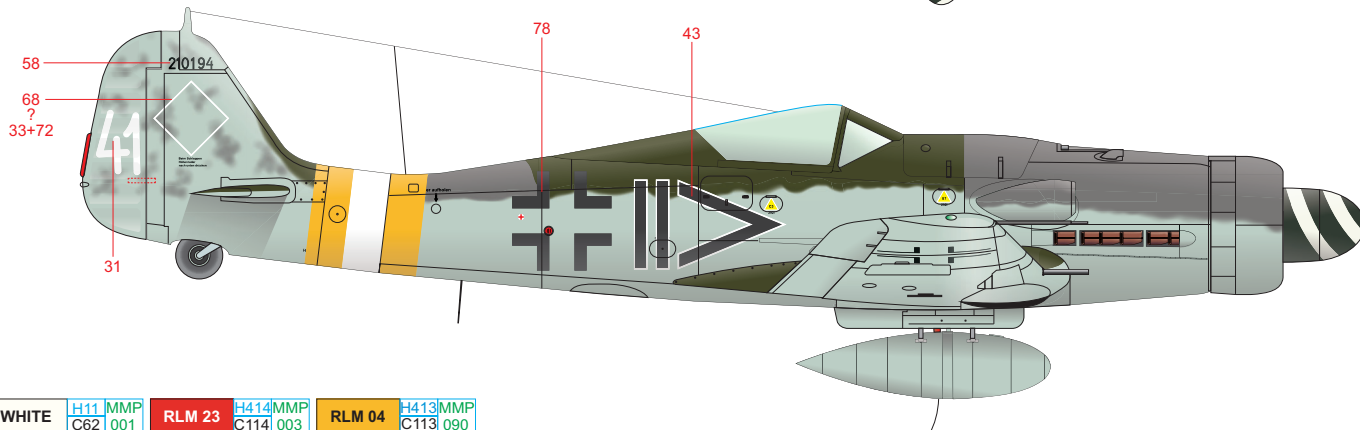
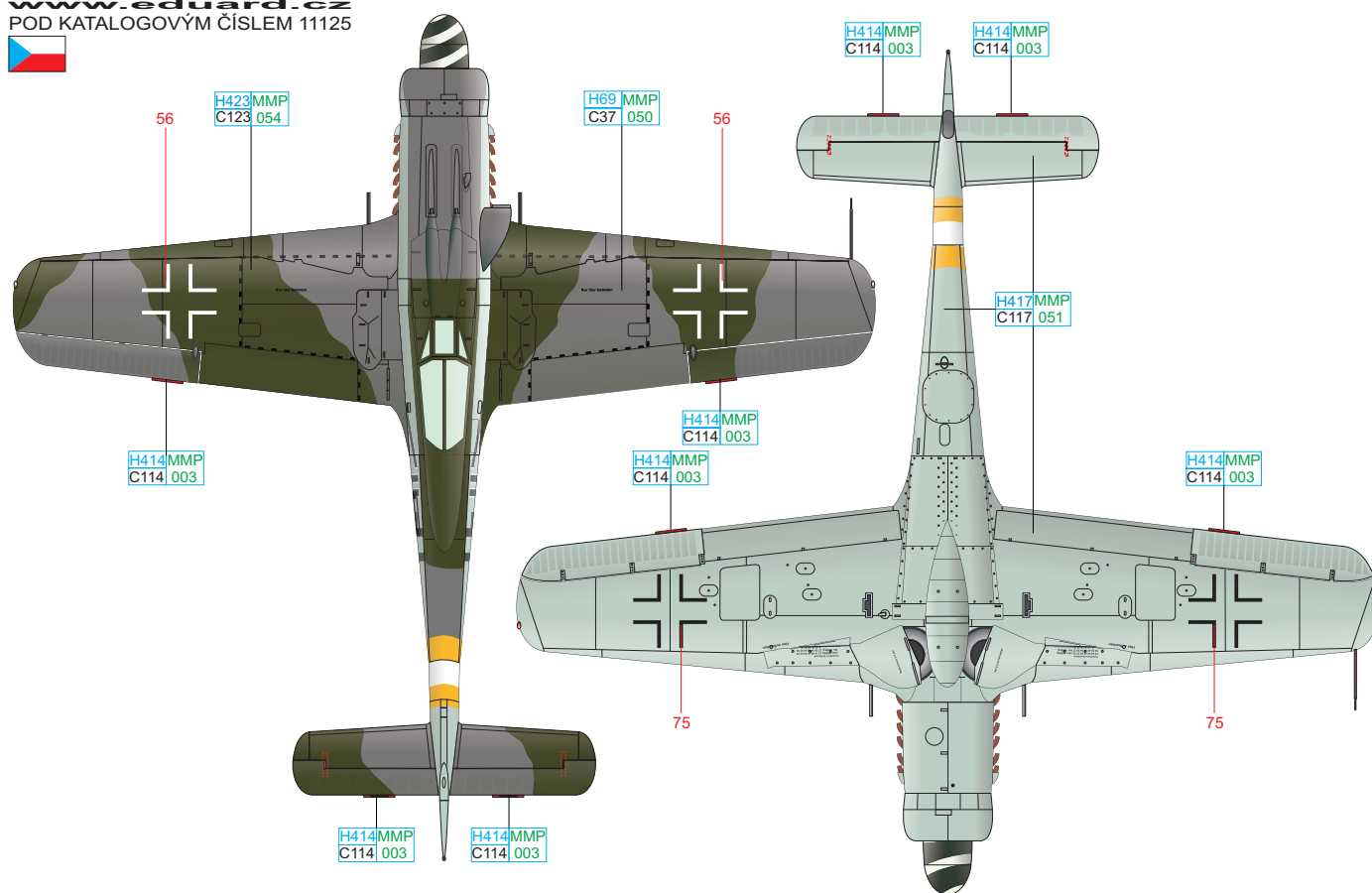

WHITE	H11 MMP C62 001	RLM 23	H414 MMP C114 003	RLM 04	H413 MMP C113 090
RLM 75	H69 MMP C37 050	RLM 83	H423 MMP C123 054	BLACK	H12 MMP C33 047
				RLM 76	H417 MMP C117 051

eduard

C

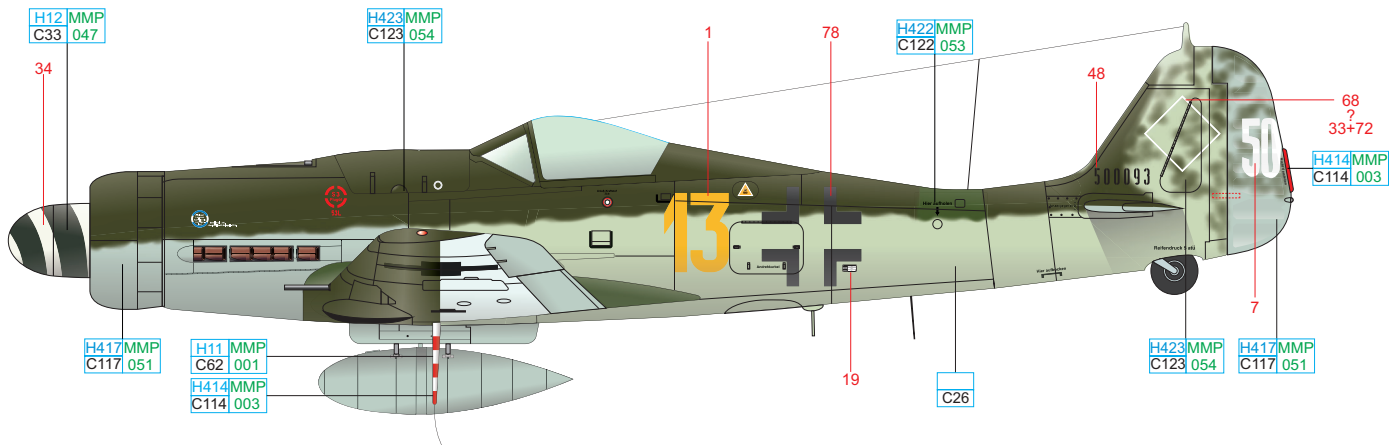

Č

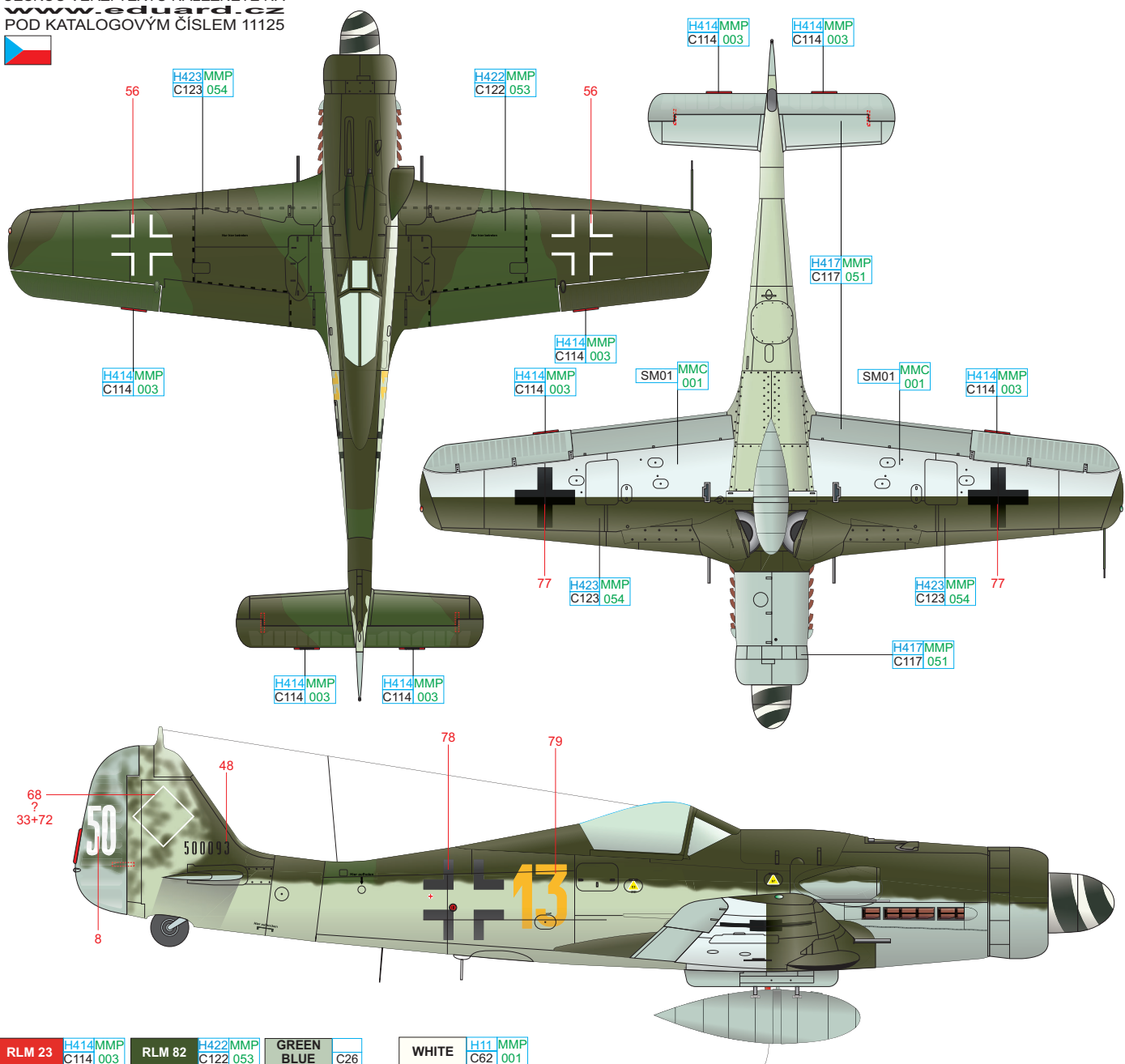

RLM 23	H414 C114	MMP 003	RLM 82	H422 C122	MMP 053	GREEN BLUE		C26	WHITE	H11 C62	MMP 001
RLM 83	H423 C123	MMP 054	BLACK	H112 C33	MMP 047	RLM 76	H417 C117	MMP 051	ALUMINIUM	SM01	MMP 001

eduard

D

21-years old Gefr.Götz also participated in the raid on Brusel - Eveve airport in the ranks of 7./JG 26, it was his first sortie. Already during the flight to the target area, Götz's aircraft was lightly damaged, having strafed the targets on Eveve airport he set on the course back home but shortly after the engine of his plane burst in flames, so he had to bale out. After he safely landed on the ground, he was taken prisoner and spent the rest of the war in captivity. Gefr.Götz's aircraft came from the assembly line of the Fieseler factory in Kassel and was camouflaged in RLM 82/83/76, the wing lower surface was partially left in the natural metal finish. The engine cowling sports irregular blotches in RLM 75 color. The aircraft appearance is a conjecture.

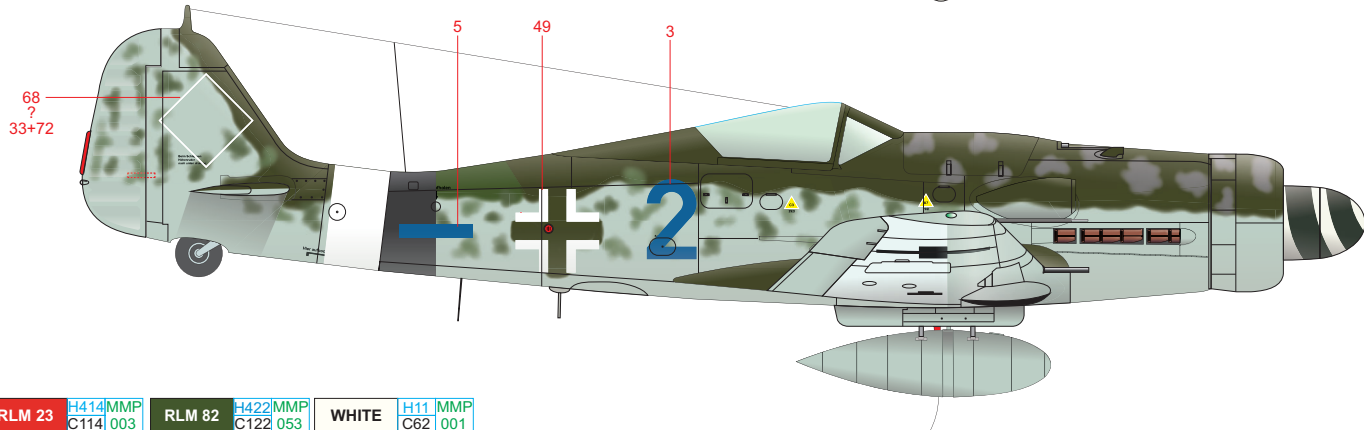
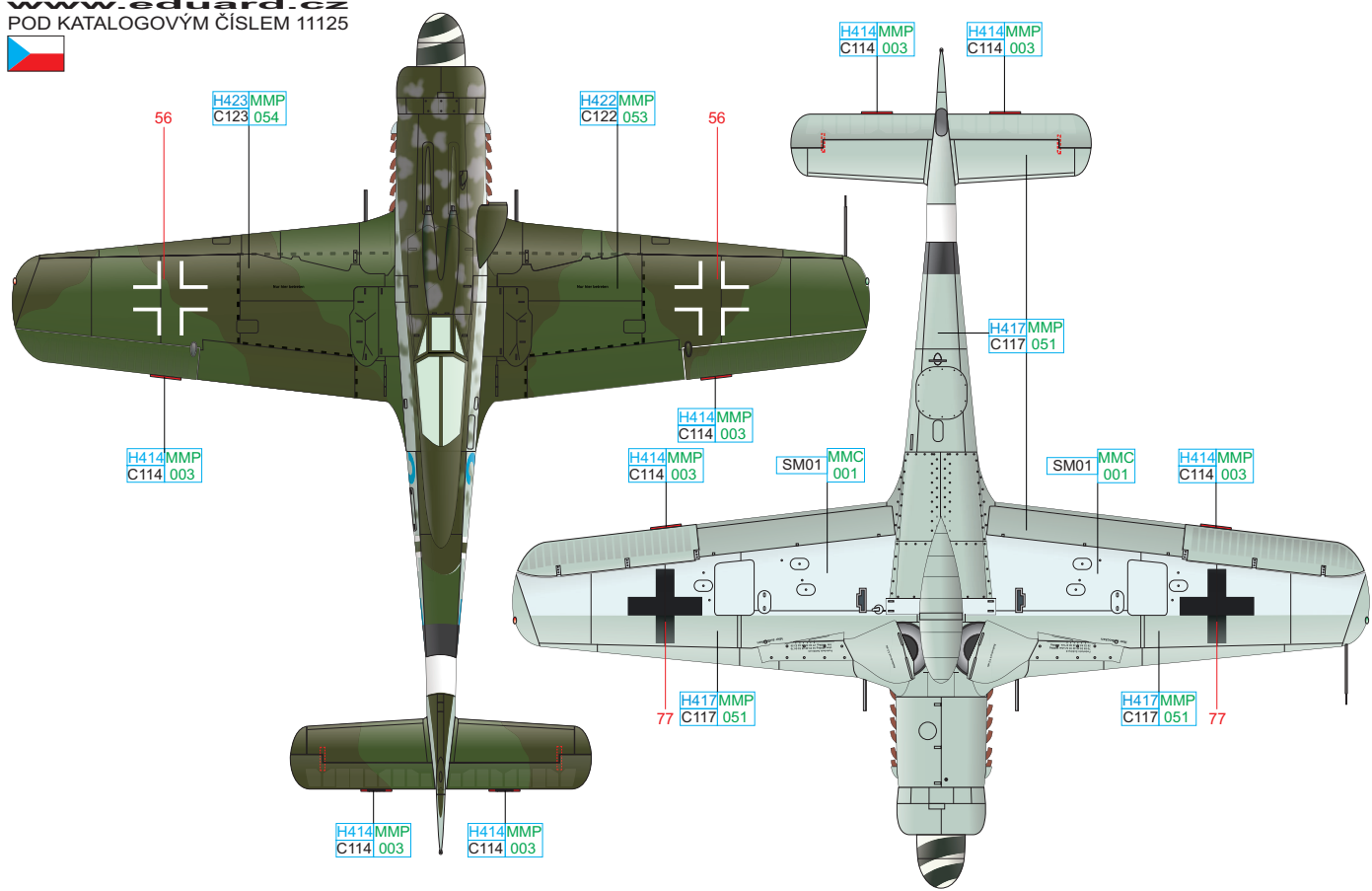
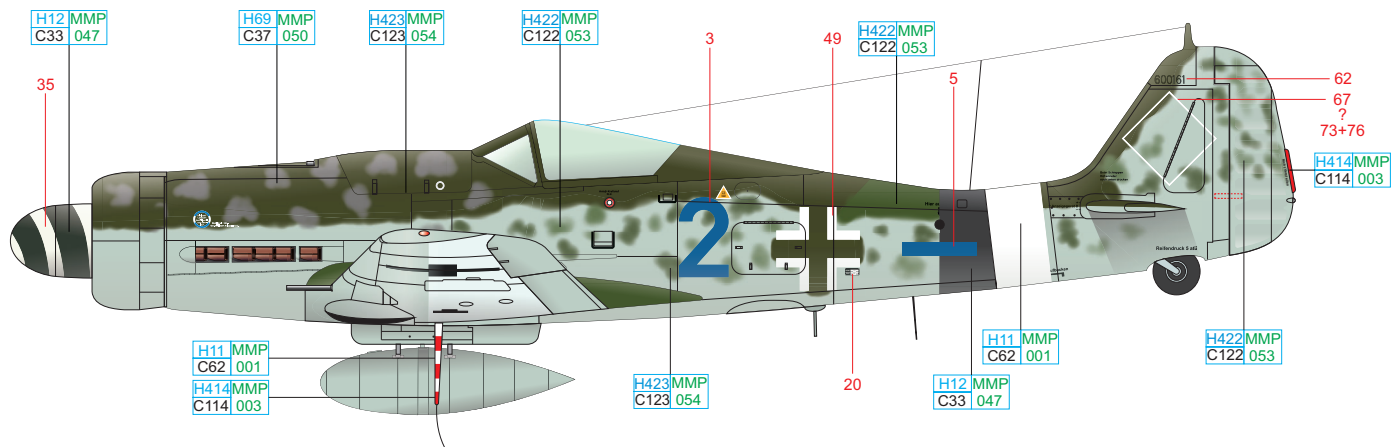

RLM 23	H414 C114	MMP 003	RLM 82	H422 C122	MMP 053	WHITE	H11 C62	MMP 001
RLM 83	H423 C123	MMP 054	BLACK	H12 C33	MMP 047	RLM 76	H417 C117	MMP 051
							ALUMINIUM	SM01
								MMC 001

eduard

E Bf 109 G-14/U4, W. Nr. 512335, flown by Othmar Heberling, 2./JG 77, Dortmund, Germany, January 1st, 1945

I., II. and III. Gruppe JG 77 commanded by Major Freytag was to participate in the attack on Antwerp - Deurne airport. The result of the attack of these three groups, equipped with total of 59 Bf 109G-10, G-14 and Bf 109K was 14 aircraft destroyed, 9 damaged for the loss of 11 aircraft and their pilots. Six of them were killed and remaining five captured. It is highly probable that Othmar Heberling flew in the ranks of 2. Staffel. The camouflage of this aircraft manufactured in Wiener Neustadt factory was spray-painted in RLM 74/75/76, originally white-painted rudder was over-sprayed in the camouflage colors. There is an Ace of Hearts painted on the aircraft nose-marking of the JG 77 aircraft. There is a I./JG 77 marking, so-called Zylinderhut, painted on the rear fuselage in front of the tail surfaces, Legion Condor and later I.(J)/LG 2 airplanes were decorated in the same manner.

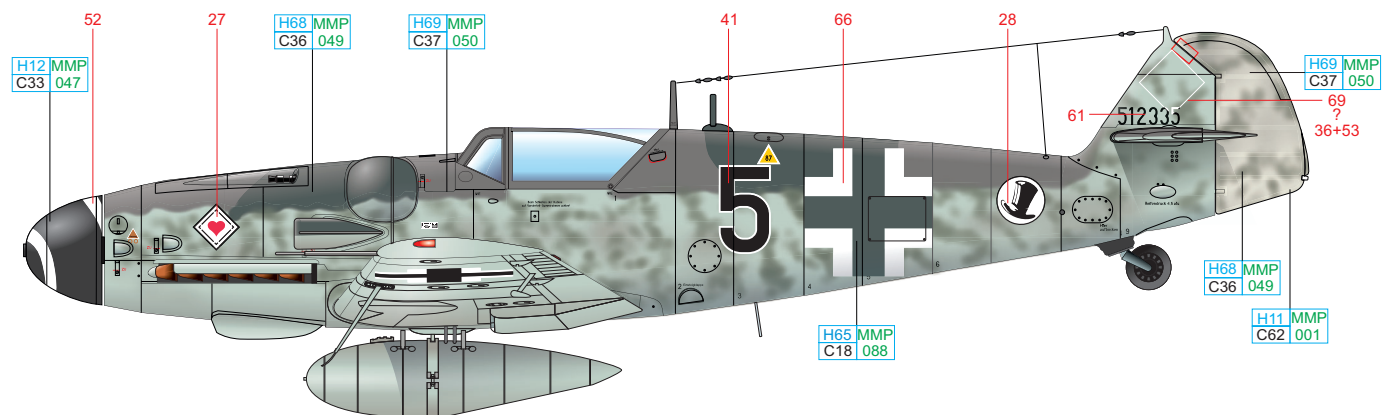

ČESKOU VERZI TEXTU NALEZNETE NA
www.eduard.cz
POD KATALOGOVÝM ČÍSLEM 11125

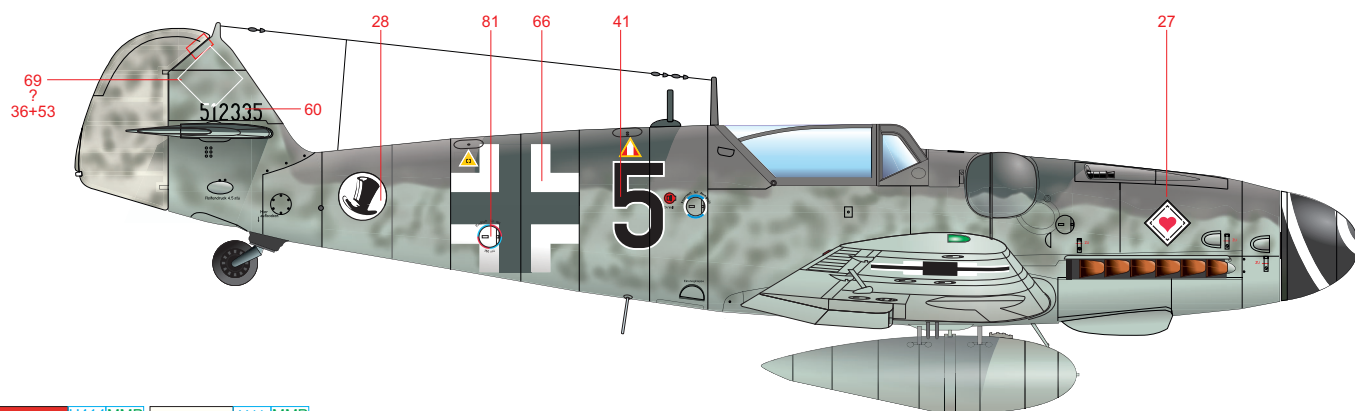
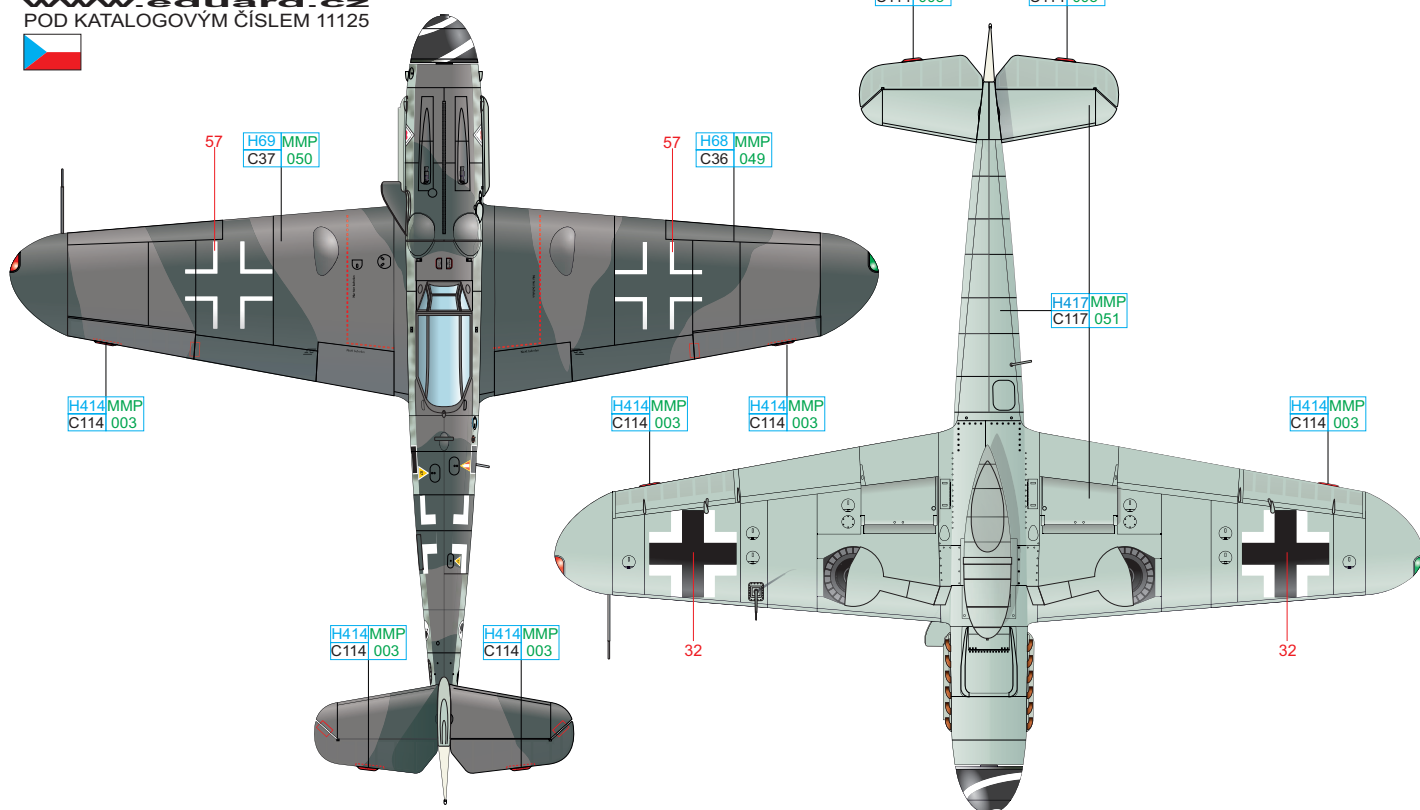

RLM 23	H414 MMP C114 003	WHITE	H11 MMP C62 001
RLM 74	H68 MMP C36 049	RLM 75	H69 MMP C37 050
		RLM 76	H417 MMP C117 051
		BLACK	H12 MMP C33 047

eduard

F

The target of the I. and III. Gruppe JG 4 was Le Culot airport but neither pilot of these groups attacked it due to the very strong anti-aircraft defense. 4. Staffel probably attacked the Ophoven airport, in the ranks of this Staffel flew 21-years old Werner Zetzschke. He was shot down nearby the town of Sittard and crashed into its street. Upon the impact he was catapulted from the cockpit and died within several minutes. He is buried in the German Military Cemetery in Ysselsteyn. Appearance of this airplane is a conjecture based on the machines from the same manufacturer's block and planes operated by I./JG 4. The camouflage was spray-painted in RLM 74/75/76 complemented by black-white-black stripe on the rear fuselage which was carried by JG 4 aircraft deployed in the Reich Defense role. There is a JG 4 marking painted on the left side of the engine cowlings, on the right side there is a I./JG 4 a rooster on the blue base, reminder of the former I. Gruppe JG 4 commander Franz Hahn.

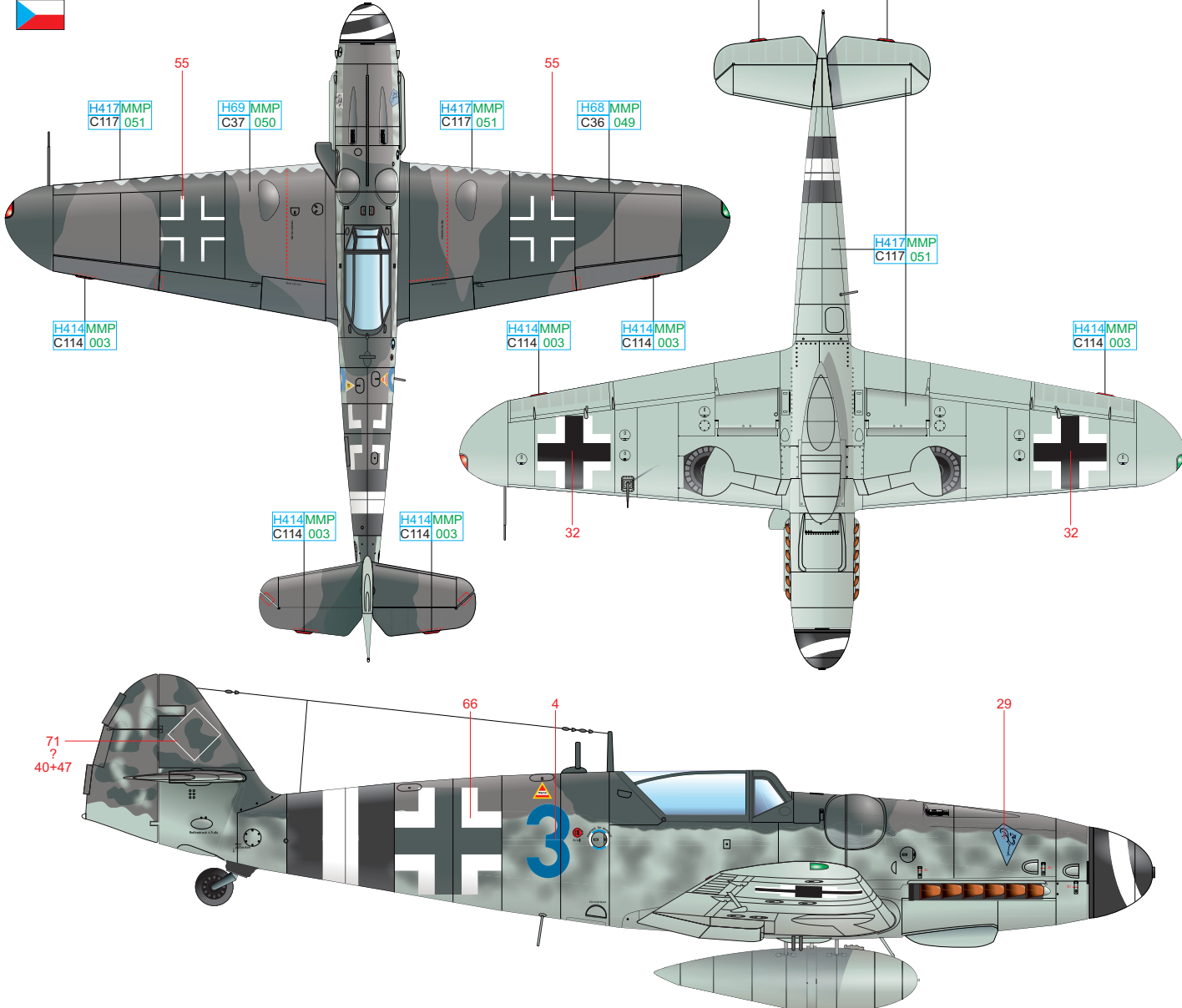
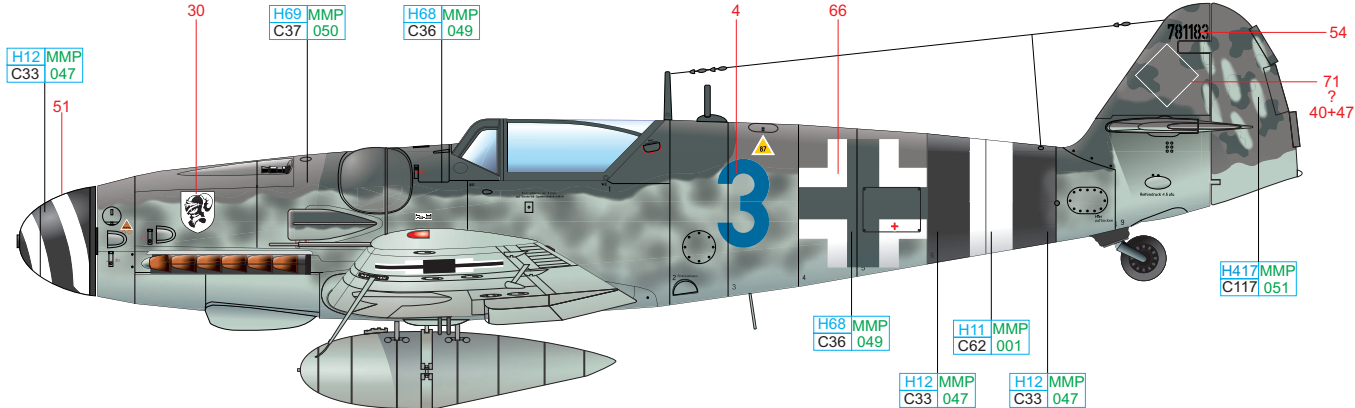

RLM 23	H414 C114	MMP 003	WHITE	H11 C62	MMP 001	BLACK	H12 C33	MMP 047
RLM 74	H68 C36	MMP 049	RLM 75	H69 C37	MMP 050	RLM 76	H417 C117	MMP 051

G

RLM 23RLM 74RLM 70RLM 75

WHITE

RLM 76

BLACK

H12	MMF
C33	047

H

In the ranks of IV./JG 53, Uffz. Maxis was to participate in the raid on Metz - Frescaty airport captured by the US troops. During the flight to the target, together with the other pilots, he attacked the 455th AAA Battalion post located nearby Ittersdorf. He was shot down however, force-landed and after getting out of the cockpit he was shot to death by the member of the Battery A of the field artillery 739th Battalion. Maxis' burial place remains unknown. Uffz. Maxis' Bf 109G-14/AS flew camouflaged in RLM 74/75/76. Vertical tail surface and rudder were manufactured by the sub-contractor and painted in the same colors with sharp-edged blotches of RLM 74. 900 mm wide black stripe around the rear fuselage indicated JG 53 aircraft deployed in the Reich Defense role.



RLM 23	H414 C114	MMP 003	RLM 70	H65 C18	MMP 088			
RLM 74	H68 C36	MMP 049	RLM 75	H69 C37	MMP 050	RLM 76	H417 C117	MMP 051
						BLACK	H12 C33	MMP 047

Fw 190D-9

STENCILING POSITIONS

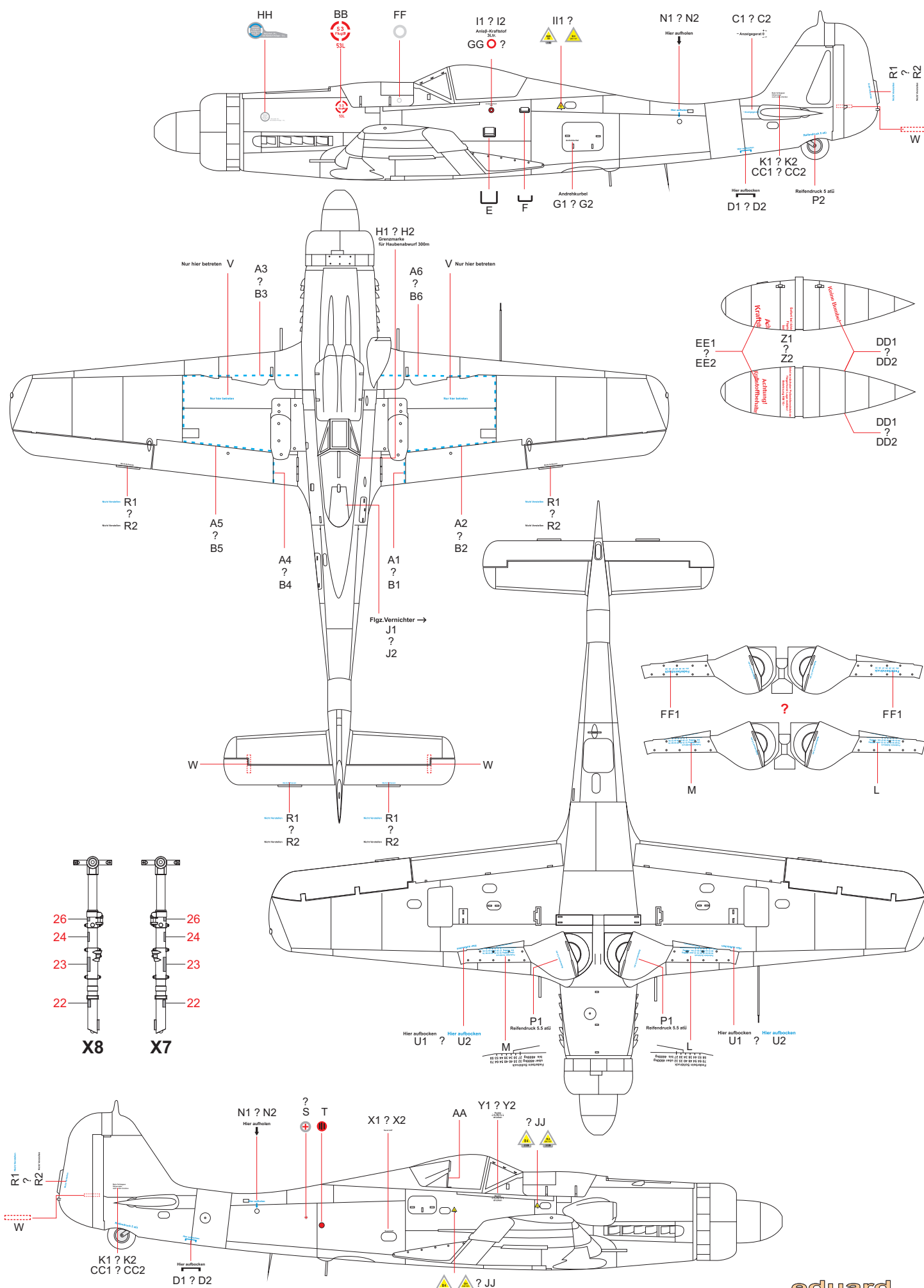

Bf 109G-14

STENCILING POSITIONS

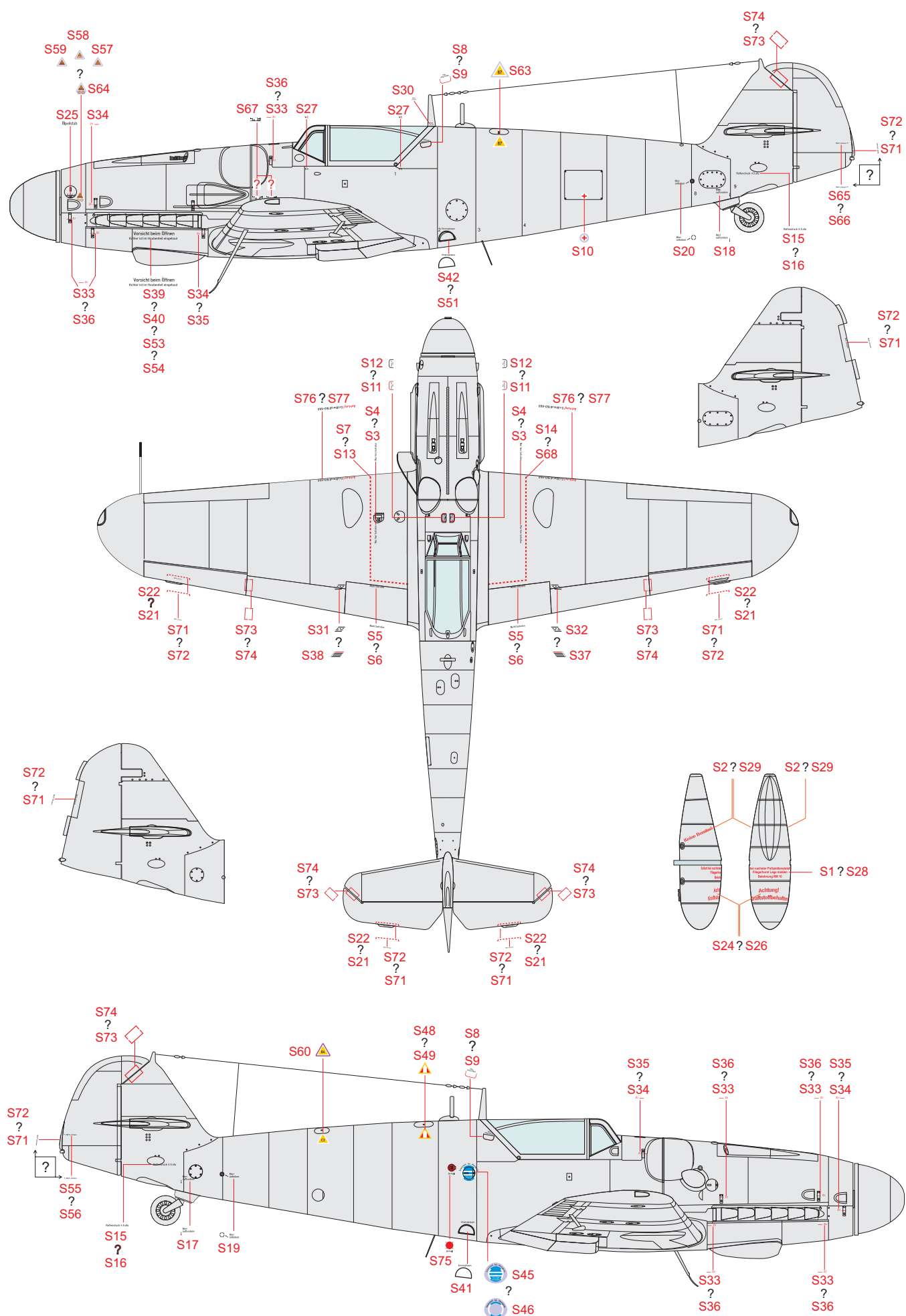

Bf 109G-14/AS

